

JANSON PLAYGROUNDS		
BLDGs IN SCOPE	DSA A#	CERTIFICATION STATUS
BLDG A	03-109172	CERTIFIED
	03-118778 4146	CERTIFIED
BLDG E	03-107659	CERTIFIED
	03-118778	CERTIFIED

- ACCESSIBILITY NOTES**
1. SITE WALKWAYS SHALL PROVIDE A BARRIER FREE PATH OF TRAVEL FOR A PERSON IN A WHEELCHAIR. THE PATH OF TRAVEL SHALL BE A HARD, DURABLE AND SLIP RESISTANT ROUTE A MINIMUM OF 48 INCHES IN WIDTH (11B-403.5.1 EXCEPTION 3) AND WITH A MAXIMUM GRADIENT SLOPE OF 5% AND MAXIMUM CROSS-SLOPE OF 2% (11B-403.3) ABRUPT CHANGES IN LEVEL SHALL NOT EXCEED A BEVELED SLOPE OF 1:2 WITH A 1/2" IN VERTICAL HEIGHT AND 1/4" MAXIMUM IN VERTICAL DIFFERENTIAL LEVELS. CONCRETE FINISH SHALL BE STABLE, FIRM AND SLIP-RESISTANT (11B-302).
 2. PATH OF TRAVEL (P.O.T.) AS INDICATED, IS A COMMON BARRIER FREE EGRESS/ACCESS ROUTE WITHOUT ANY ABRUPT VERTICAL CHANGES EXCEEDING 1/2" BEVELED AT 1:2 MAXIMUM SLOPE, EXCEPT THAT LEVEL CHANGES DO NOT EXCEED 1/4" VERTICAL AND IS AT LEAST 48" WIDE. THE PATH SURFACE IS SLIP RESISTANT, STABLE, FIRM, AND SMOOTH. PASSING SPACES (11B-403.5.3) AT LEAST 60" X 60" ARE LOCATED NOT MORE THAN 200' APART. PARTS OF P.O.T. WITH CONTINUOUS GRADIENTS HAVE 60' LEVEL AREAS (11B-403.7) NOT MORE THAN 400' APART. THE CROSS-SLOPE DOES NOT EXCEED 2% AND SLOPE IN THE DIRECTION OF TRAVEL IS LESS THAN 5% UNLESS OTHERWISE INDICATED. (P.O.T.) SHALL BE MAINTAINED FREE OF OVERHANGING OBSTRUCTIONS TO 80" MINIMUM (11B-307.4) AND PROTRUDING OBJECTS GREATER THAN 4" PROJECTION FROM WALL AND ABOVE 27" AND LESS THAN 80" (11B-307.2). THE ARCHITECT HAS VERIFIED ARE THAT THERE ARE NO BARRIERS IN THE P.O.T.
 3. GATES IN THE PATH OF TRAVEL SHALL HAVE ACCESSIBLE HARDWARE AND KICK PLATES.
 4. FOR ALL SITE GRADIENTS SEE CIVIL PLANS

PATH OF TRAVEL STATEMENT

DESIGN PROFESSIONAL IN GENERAL, RESPONSIBLE CHARGE STATEMENT: THE P.O.T. IDENTIFIED IN THESE CONSTRUCTION DOCUMENTS MEETS THE REQUIREMENTS OF THE CURRENT APPLICABLE CALIFORNIA BUILDING CODE (CBC) ACCESSIBILITY PROVISIONS FOR PATH OF TRAVEL REQUIREMENTS FOR ALTERATIONS, ADDITIONS AND STRUCTURAL REPAIRS. AS PART OF THE DESIGN OF THIS PROJECT, THE P.O.T. WAS EXAMINED AND ANY ELEMENTS, COMPONENTS, OR PORTIONS OF THE P.O.T. THAT WERE DETERMINED TO BE NONCOMPLIANT WITH THE CBC HAVE BEEN IDENTIFIED AND THE CORRECTIVE WORK NECESSARY TO BRING THEM INTO COMPLIANCE HAS BEEN INCLUDED WITHIN THE SCOPE OF THIS PROJECT'S WORK THROUGH DETAILS, DRAWINGS AND SPECIFICATIONS INCORPORATED INTO THESE CONSTRUCTION DOCUMENTS. ANY NONCOMPLIANT ELEMENTS, COMPONENTS OR PORTIONS OF THE P.O.T. THAT WILL NOT BE CORRECTED BY THIS PROJECT BASED ON VALUATION THRESHOLD LIMITATIONS OR A FINDING OF UNREASONABLE HARDSHIP ARE INDICATED IN THESE CONSTRUCTION DOCUMENTS.

DURING CONSTRUCTION, IF P.O.T. ITEMS WITHIN THE SCOPE OF THE PROJECT REPRESENTED AS CBC COMPLIANT ARE FOUND TO BE CONFORMING BEYOND REASONABLE CONSTRUCTION TOLERANCES, THE ITEMS SHALL BE BROUGHT INTO COMPLIANCE WITH THE CBC AS PART OF THIS PROJECT BY MEANS OF A CONSTRUCTION CHANGE DOCUMENT.

LEGEND

LANDSCAPE

SCOPE OF WORK

ACCESSIBLE PATH OF TRAVEL (POT)

- KEYNOTES**
- 1 NEW PLAYGROUNDS
 - 2 PROVIDE NEW STRIPING AT ENTIRE PARKING LOT AS PER DETAIL #9/A8.02
 - 3 PROVIDE NEW ADA PARKING SIGNS PER 10/A8.02
 - 4 PROVIDE NEW TOW AWAY SIGN ON (N) POLE PER DETAIL 7/A8.02
 - 5 REMOVE EXISTING SIGNAGE AND REPLACE WITH NEW ACCESSIBLE RESTROOM DOOR SIGN. SEE, 4/8.04
 - 6 REMOVE EXISTING WALL SIGNAGE AND REPLACE WITH NEW ACCESSIBLE RESTROOM WALL SIGN. SEE, 2 & 3/A8.04
 - 7 (E) TOW AWAY SIGN PER A#03-122693
 - 8 (E) ADA PARKING SIGN PER A#03-122693

FILE No.: 19-91 A#: 03-123587

REV. DATE DESCRIPTION

2221

ARCHITECT

STATE OF CALIFORNIA

DRAWINGS, SPECIFICATIONS AND OTHER DOCUMENTS SHALL BE PROVIDED TO THE CLIENT FOR REVIEW AND APPROVAL. THE CLIENT SHALL BE RESPONSIBLE FOR OBTAINING ALL NECESSARY PERMITS AND APPROVALS FROM THE APPROPRIATE AGENCIES. THE CLIENT SHALL BE RESPONSIBLE FOR OBTAINING ALL NECESSARY PERMITS AND APPROVALS FROM THE APPROPRIATE AGENCIES.

ROSEMEAD SCHOOL DISTRICT
MILDRED B. JANSON ELEMENTARY SCHOOL
CONSTRUCTION OF NEW PLAYGROUNDS
8628 MARSHALL ST. ROSEMEAD, CA 91770

ROSEMEAD SCHOOL DISTRICT
3807 ROSEMEAD BLVD.,
ROSEMEAD, CA 91770

NAC
ARCHITECTURE
nacarchitecture.com
837 N. Spring Street, Third Floor
Los Angeles, CA 90012-2323
P: 323.475.8075

NAC NO: 161-23078
DRAWN: AF
CHECKED: MO, GC
DATE: 08/30/2023

SITE PLAN



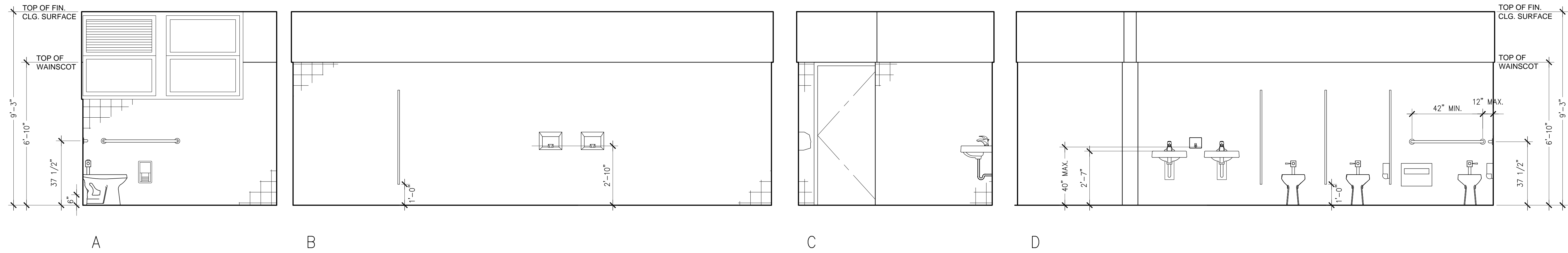

3 INTERIOR ELEVATION: EXISTING ACCESSIBLE GIRL'S TOILET - BUILDING 'E' (EXISTING CONDITION FOR REFERENCE ONLY, NO NEW SCOPE)
SCALE: 1/2" = 1'-0"

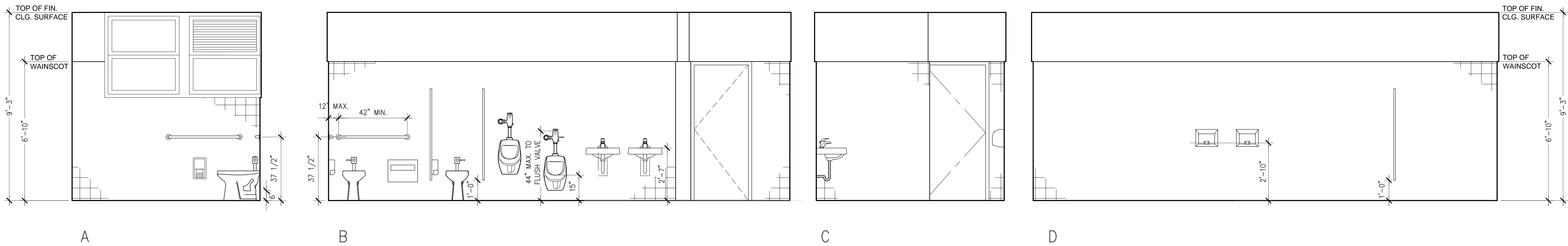

2 INTERIOR ELEVATION: EXISTING ACCESSIBLE BOY'S TOILET - BUILDING 'E' (EXISTING CONDITION FOR REFERENCE ONLY, NO NEW SCOPE)
SCALE: 1/2" = 1'-0"

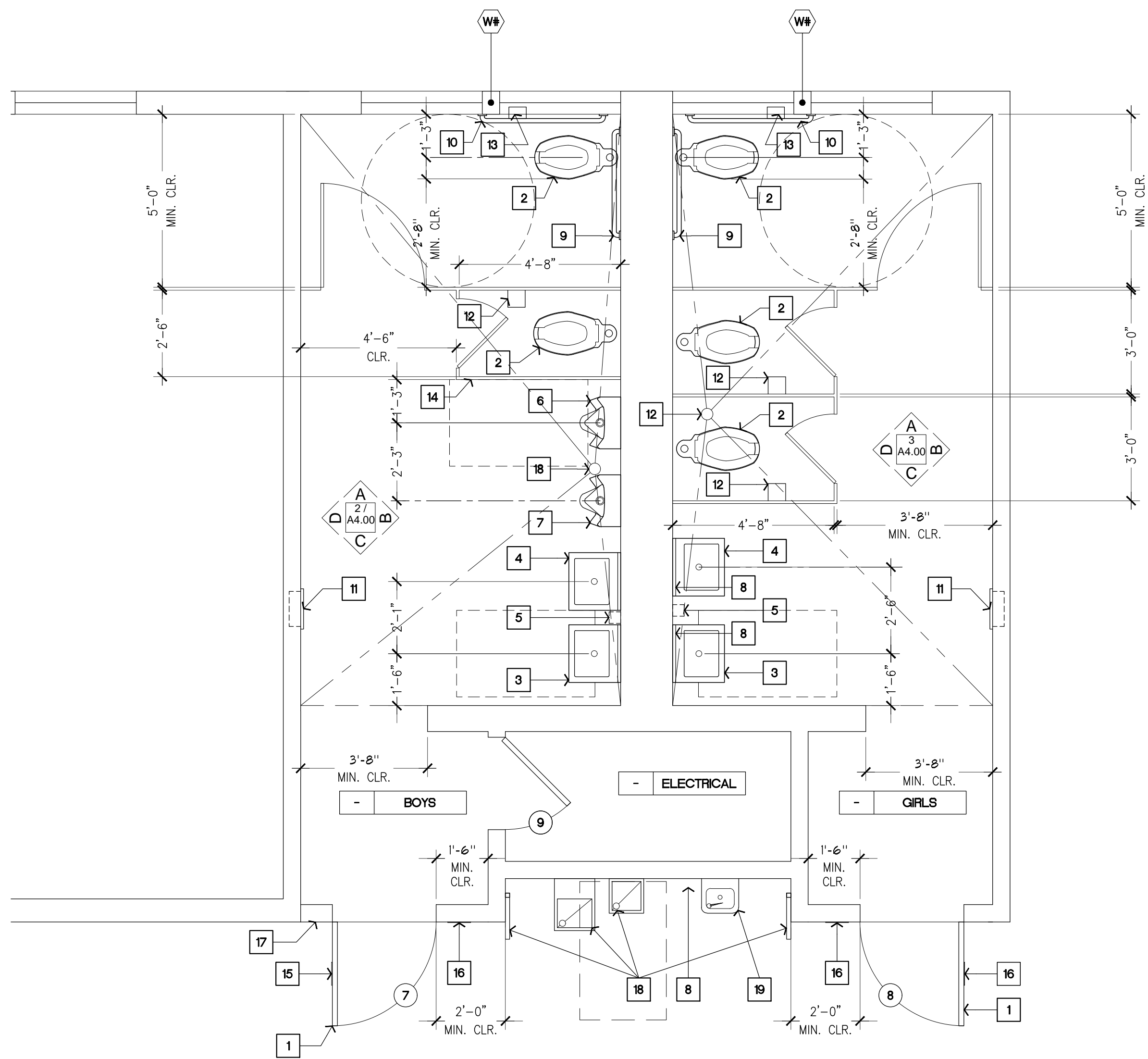

1 ENLARGED EXISTING FLOOR PLAN: ACCESSIBLE BOYS AND GIRLS TOILETS - BLDG. 'E'
SCALE: 3/8" = 1'-0"

- KEYNOTES**
- (E) H.M. DOOR, DOOR FRAME ASSEMBLY AND THRESHOLD WITH ADA LEVER HARDWARE.
 - (E) ACCESSIBLE FLOOR MOUNTED WATER CLOSET W/ SENSOR FLUSH VALVES AND CONTROLS.
 - (E) ACCESSIBLE LAVATORY W/ SENSOR FAUCET FIXTURE CONTROL VALVES.
 - (E) LAVATORY W/ SENSOR FAUCET FIXTURE CONTROL VALVES.
 - (E) SURFACE MOUNTED STAINLESS STEEL SOAP DISPENSER.
 - (E) ACCESSIBLE WALL MOUNTED WATERLESS URINAL.
 - (E) WALL MOUNTED WATERLESS URINAL.
 - (E) 6"W x 6"H CT.
 - (E) ACCESSIBLE 36" GRAB BAR.
 - (E) ACCESSIBLE 42" GRAB BAR.
 - (E) RECESSED STAINLESS STEEL PAPER ROLL TOWEL DISPENSER/WASTE RECEPTACLE.
 - (E) SURFACE MOUNTED STAINLESS STEEL CONTINUOUS ROLL TOILET PAPER DISPENSER.
 - (E) RECESSED STAINLESS STEEL CONTINUOUS ROLL TOILET PAPER DISPENSER.
 - (E) PHENOLIC TOILET PARTITIONS. INSTALL 3'-0" W. PARTITION DOOR AT ACCESSIBLE TOILET PARTITION.
 - REMOVE EXISTING AND INSTALL NEW ACCESSIBLE DOOR MOUNTED RESTROOM SIGNAGE. SEE DETAIL A/A8.04
 - REMOVE EXISTING AND INSTALL NEW ACCESSIBLE WALL MOUNTED RESTROOM SIGNAGE. SEE DETAIL 2 & 3/A8.04
 - (E) FLOOR DRAIN.
 - REMOVE EXISTING DRINKING FOUNTAINS AND GUARDRAILS AND PROVIDE NEW ADA HI/LOW DF AS PER DETAIL 1/A8.03
 - REMOVE EXISTING NON COMPLIANT DRINKING FOUNTAIN. PATCH AREA TO MATCH (E) PLASTER. PAINT TO MATCH EXISTING.

- LEGEND**
- EXISTING 2X WOOD STUD WALL

FILE No.: 19-91 AH: 03-123587

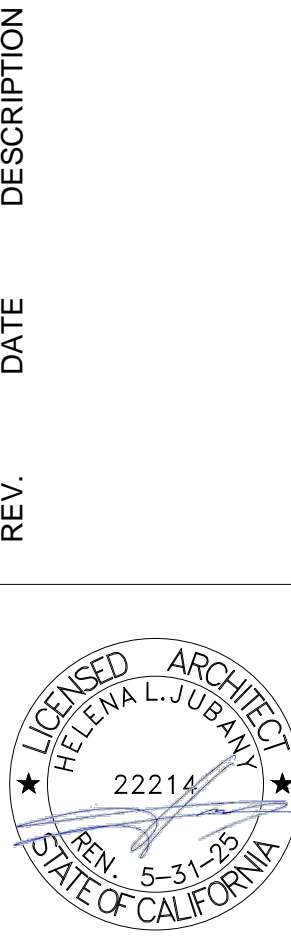

DESIGNING, SPECIFYING AND OTHER PROFESSIONAL ARCHITECTURAL SERVICES FOR THE PROJECT FOR WHICH THE ARCHITECT IS REGISTERED IN THE STATE OF CALIFORNIA. THE ARCHITECT'S SEAL AND SIGNATURE ARE REQUIRED ON ALL SETS OF PLANS AND SPECIFICATIONS. EXCEPT BY REPRESENTATION IN WRITING.

ROSEMEAD SCHOOL DISTRICT
MILDRED B. JANSON ELEMENTARY SCHOOL
CONSTRUCTION OF NEW PLAYGROUNDS
8628 MARSHALL ST., ROSEMEAD, CA 91770

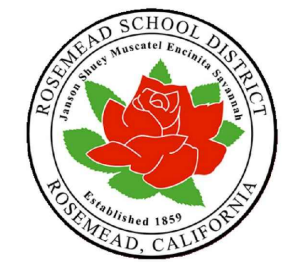

ROSEMEAD
SCHOOL DISTRICT
3607 ROSEMEAD BLVD.,
ROSEMEAD, CA 91770

NAC
ARCHITECTURE
nacarchitecture.com
837 N. Spring Street, Third Floor
Los Angeles, CA 90012-2323
P: 323.475.8075

NAC NO 161-23078
DRAWN AF
CHECKED MO, GC
DATE 08/30/2023

ENLARGED EXISTING
FLOOR PLAN - BOYS
AND GIRLS TOILETS -
BLDG. E

A1.01

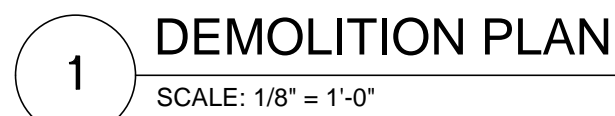

DEMOLITION PLAN

SCALE: 1/8" = 1'-0"



1.0	REMOVE EXISTING GRASS AND PREPARE AREA FOR NEW PLAYGROUND.
2.0	REMOVE SECTION OF EXISTING FENCE, POSTS AND ASSOCIATED FOOTINGS.
3.0	PROTECT EXISTING ELECTRICAL PULL BOX DURING CONSTRUCTION.
4.0	REMOVE EXISTING PLAYGROUND EQUIPMENT AND THEIR ASSOCIATED CONCRETE FOOTINGS. DEMOLISH EXISTING CONCRETE CURB.

FILE No.: 19-91 A#: 03-123587

REV.	DATE	DESCRIPTION
------	------	-------------



DRAWINGS, SPECIFICATIONS AND OTHER VISUAL AIDS, AS INSTRUMENTS OF SERVICE, ARE THE PROPERTY OF THE ARCHITECT. IF THE CLIENT WANTS TO REUSE THEM, THE ARCHITECT MUST BE CONSULTED TO DETERMINE WHETHER THE PROJECT FOR WHICH THEY ARE MADE BE EXECUTED OR NOT, AND IF NOT, ARE NOT TO BE USED FOR ANY OTHER PROJECT THAN THE ONE FOR WHICH THEY ARE PREPARED, EXCEPT BY AGREEMENT IN WRITING.

ROSEMEAD SCHOOL DISTRICT
MILDRED B. JANSON ELEMENTARY SCHOOL
CONSTRUCTION OF NEW PLAYGROUNDS



ROSEMEAD
SCHOOL DISTRICT
3907 ROSEMEAD BLVD.,
ROSEMEAD, CA 91770

NAC
ARCHITECTURE
nacarchitecture.com
837 N. Spring Street, Third Floor
Los Angeles, CA 90012-2323
P:323.475.8075

NAC NO 161-23078
DRAWN AF
CHECKED MO,GC
DATE 08/30/2023

DEMOLITION PLAN

A2.00



DRAWING, SPECIFICATIONS AND OTHER INFORMATION ARE THE PROPERTY OF THE ARCHITECT. NO PART OF THIS DRAWING IS TO BE REPRODUCED OR TRANSMITTED IN ANY FORM OR BY ANY MEANS, ELECTRONIC OR MECHANICAL, WITHOUT THE WRITTEN PERMISSION OF THE ARCHITECT. THE ARCHITECT ASSUMES NO LIABILITY FOR ANY DAMAGE OR INJURY TO PERSONS OR PROPERTY, OR FOR ANY CONSEQUENCES OF ANY ACTION TAKEN OR NOT TAKEN, BASED ON THIS DRAWING, EXCEPT IN ACCORDANCE WITH THE PROFESSIONAL STANDARD OF CARE.

ROSEMEAD SCHOOL DISTRICT
MILDRED B. JANSON ELEMENTARY SCHOOL
CONSTRUCTION OF NEW PLAYGROUNDS

8628 MARSHALL ST. ROSEMEAD, CA 91770

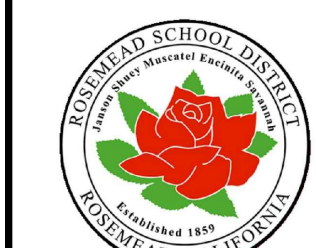

ROSEMEAD
SCHOOL DISTRICT
3607 ROSEMEAD BLVD.,
ROSEMEAD, CA 91770

NAC
ARCHITECTURE
nacarchitecture.com
837 N. Spring Street, Third Floor
Los Angeles, CA 90012-2323
P: 323.475.8075

NAC NO: 161-23078
DRAWN: AF
CHECKED: MO, GC
DATE: 08/30/2023

CONSTRUCTION
PLAN

A3.00

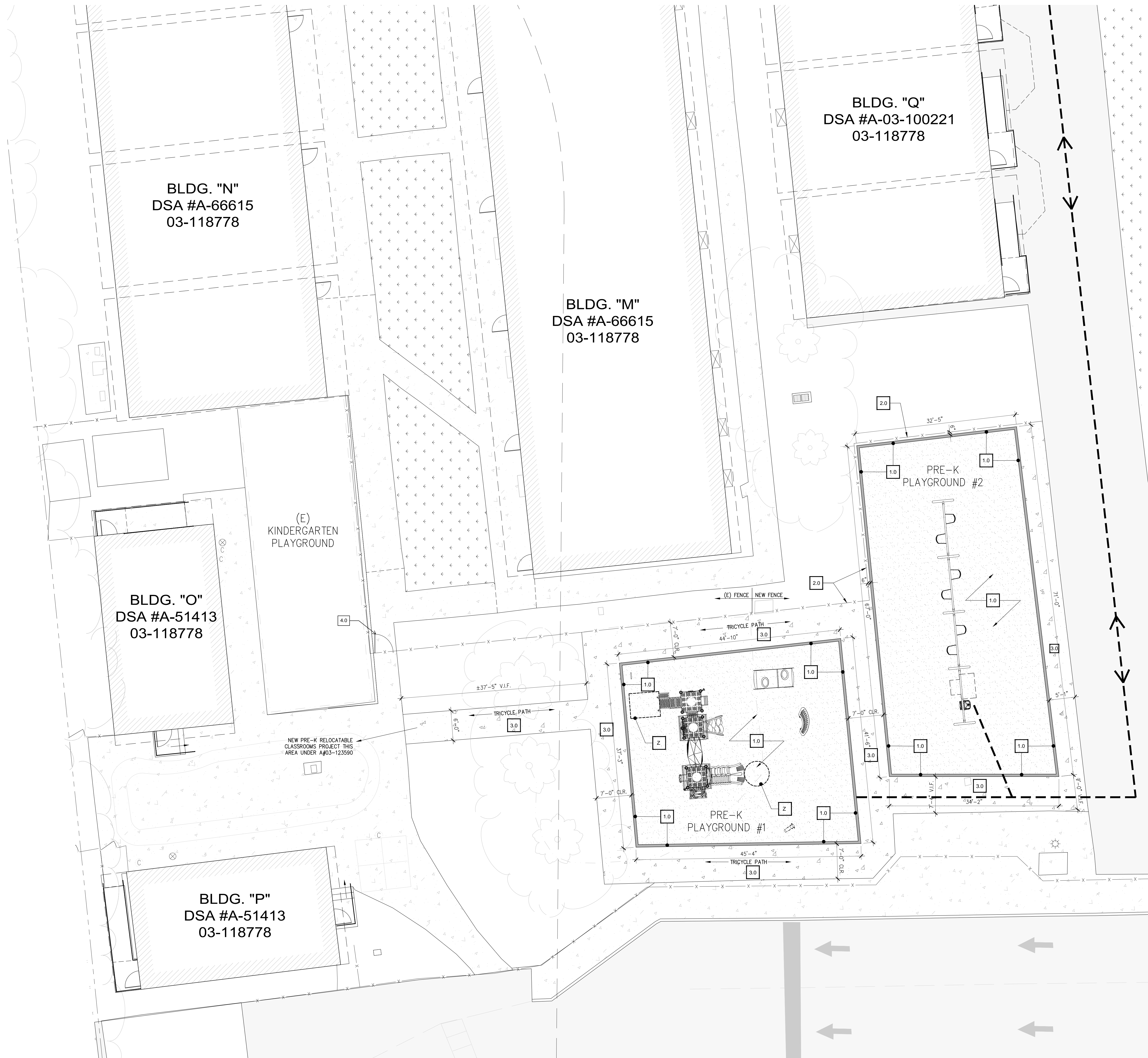

KEYNOTES

- 1.0 NEW PLAYGROUND EQUIPMENT AND SURFACING WITH NEW 6" CONCRETE CURB. SEE DETAIL 5/C2.01 FOR MORE INFO.
- 2.0 NEW CHAIN LINK FENCING, POSTS AND FOOTINGS. SEE DETAIL 2/A8.05
- 3.0 NEW 4" CONCRETE SLAB ON GRADE. SEE DETAIL 1/C2.01 FOR MORE INFO.
- 2 NEW PLAYGROUND EQUIPMENT
- 4.0 NEW CHAIN LINK GATE, PER DETAIL 1/A8.05

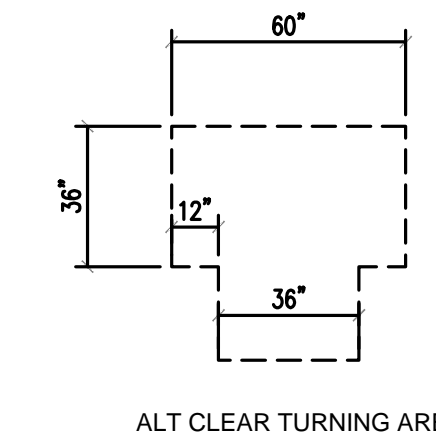
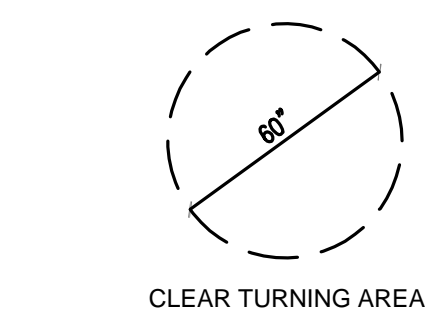
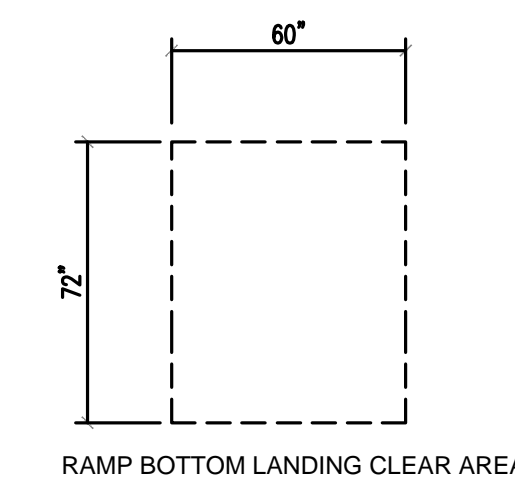

ADA ACCESSIBLE PLAYGROUND COMPONENTS

	NUMBER OF ELEVATED COMPONENTS PROVIDED	MINIMUM NUMBER OF GROUND LEVEL PLAY COMPONENTS ON AN ACCESSIBLE ROUTE	MINIMUM NUMBER OF DIFFERENT TYPES OF GROUND LEVEL PLAY COMPONENTS ON AN ACCESSIBLE ROUTE
PRE-K PLAYGROUND #1	3	2	2
PRE-K PLAYGROUND #2	NO ELEVATED COMPONENTS. 7 SWING SETS PROVIDED	1	1



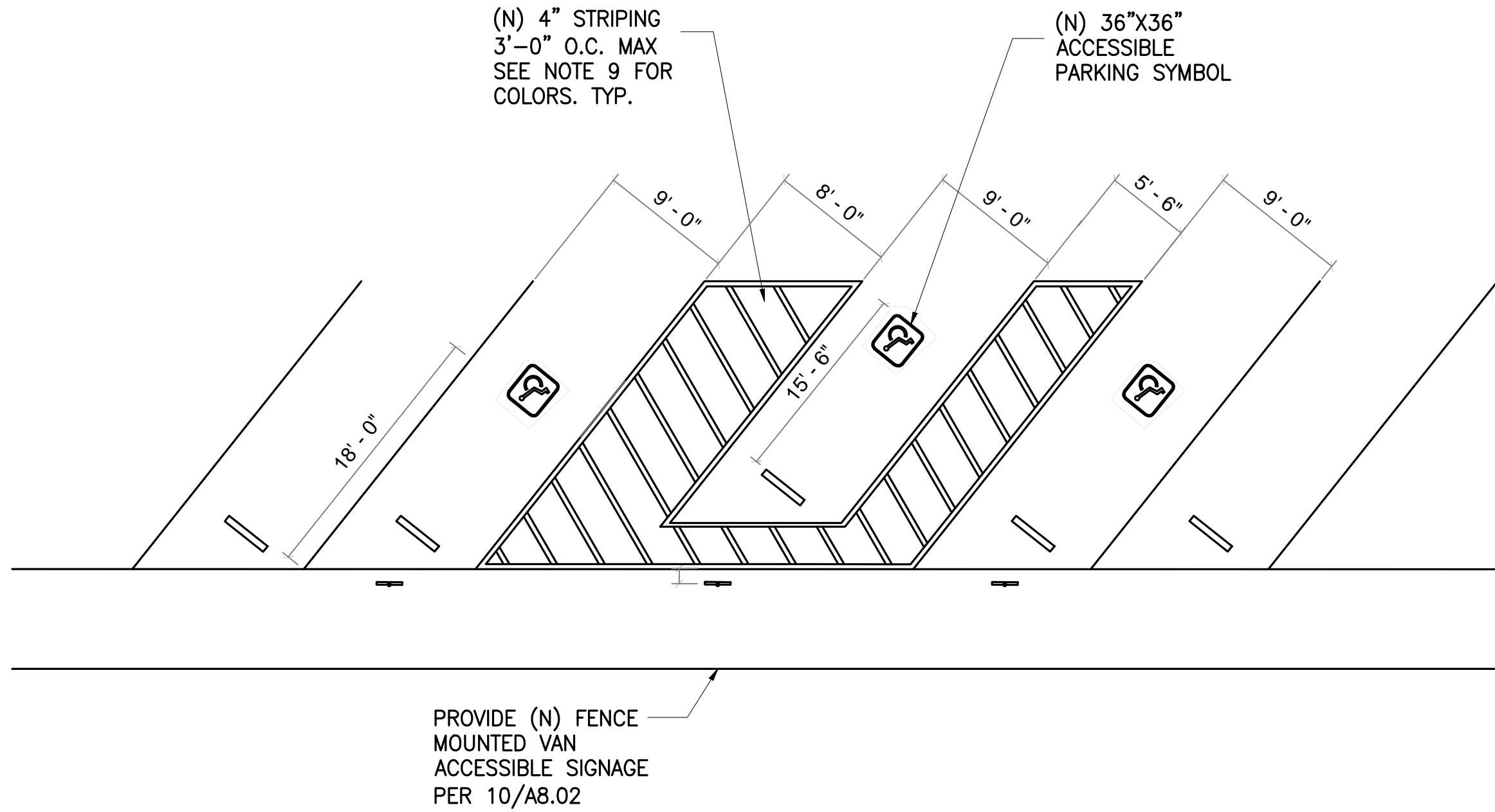

9 PARKING STRIPING

N.T.S.

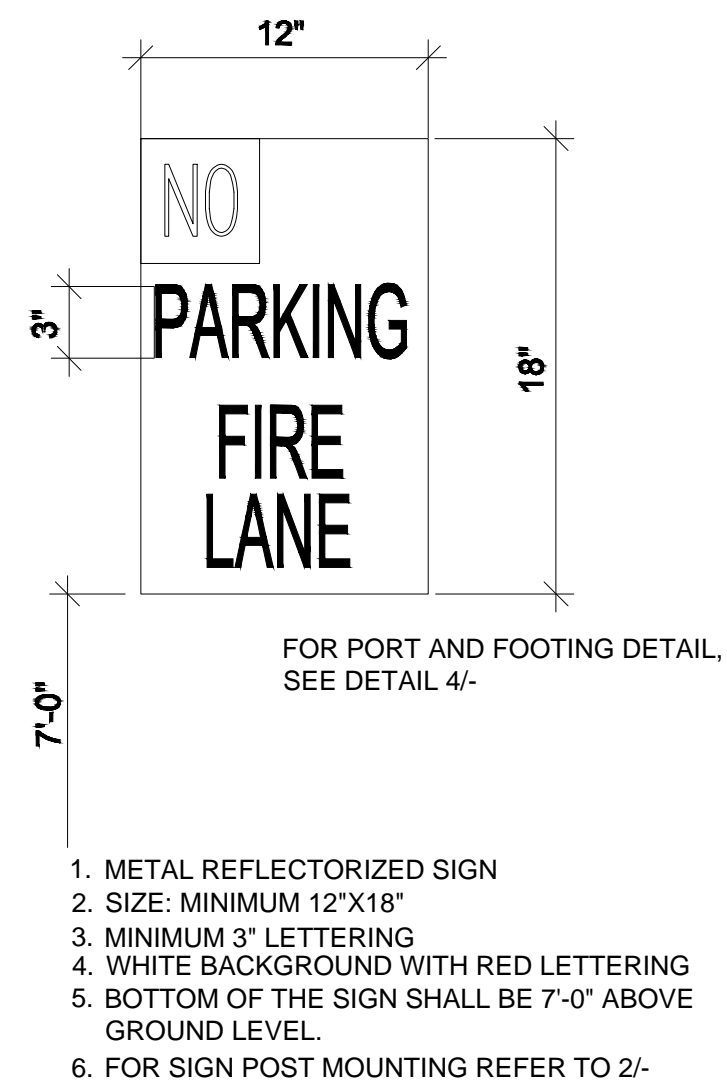

8 FIRE LANE SIGNAGE

Scale: 3/16\" = 1'-0"

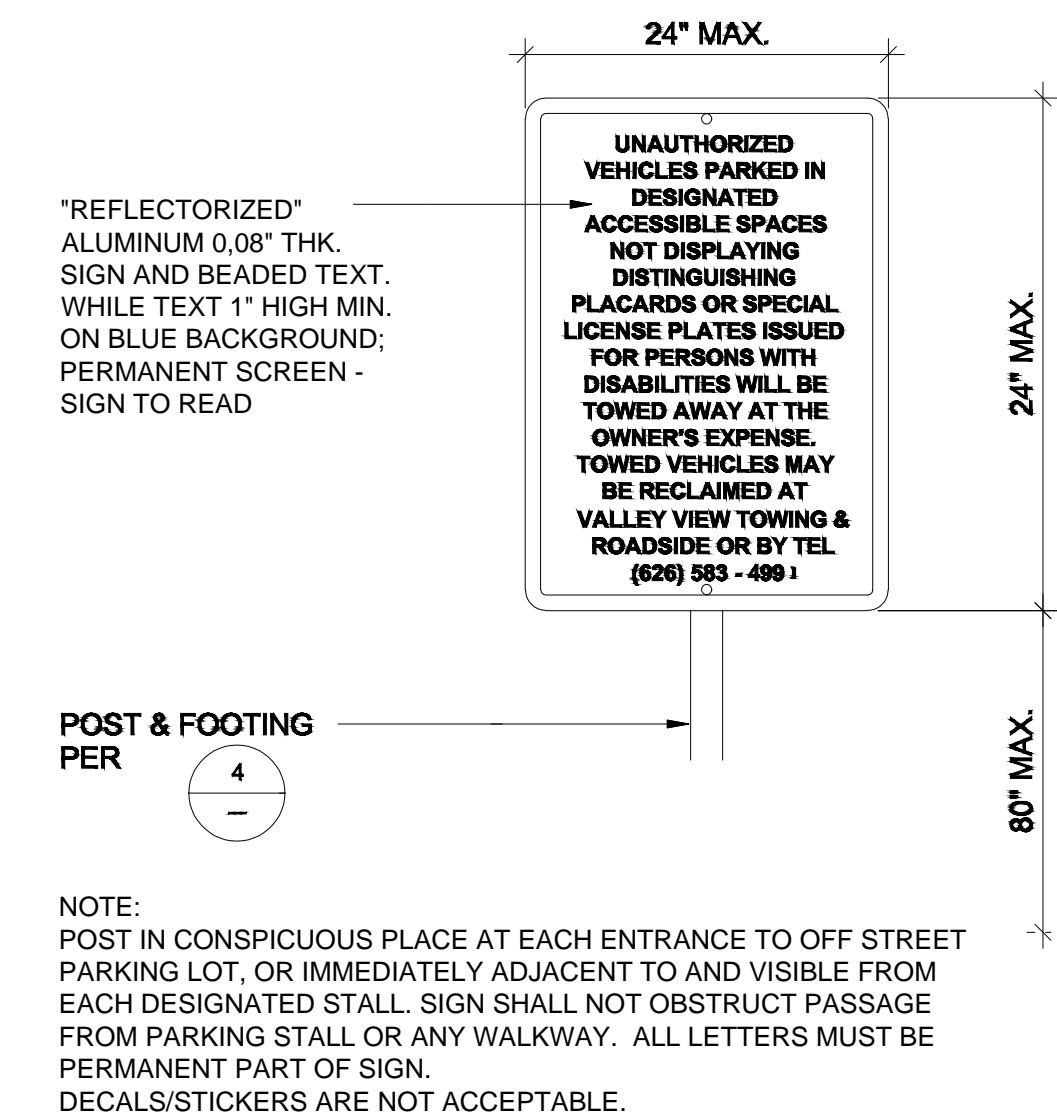

7 TOW AWAY PARKING LOT SIGN

Scale: 1 1/2\" = 1'-0"

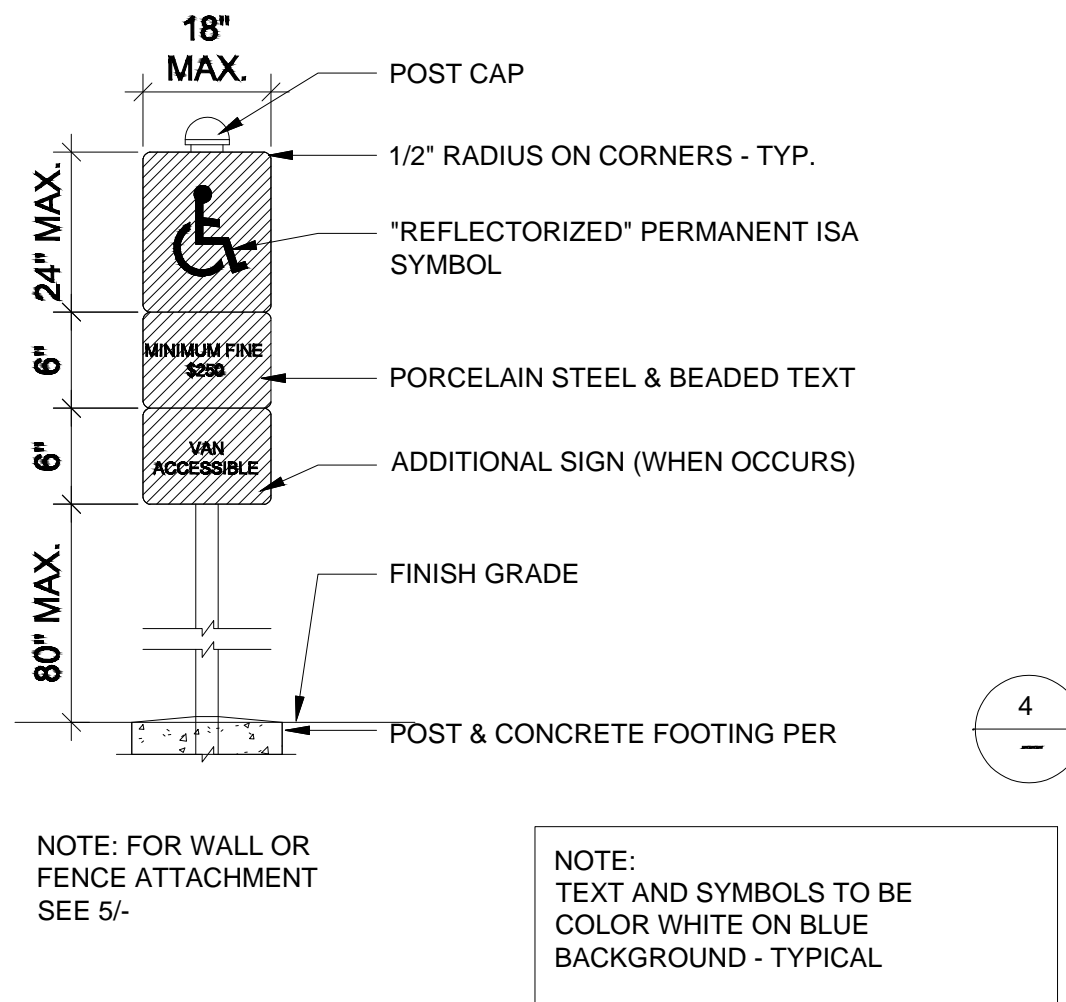

6 ACCESSIBLE PARKING SYMBOL

Scale: 1\" = 1'-0"

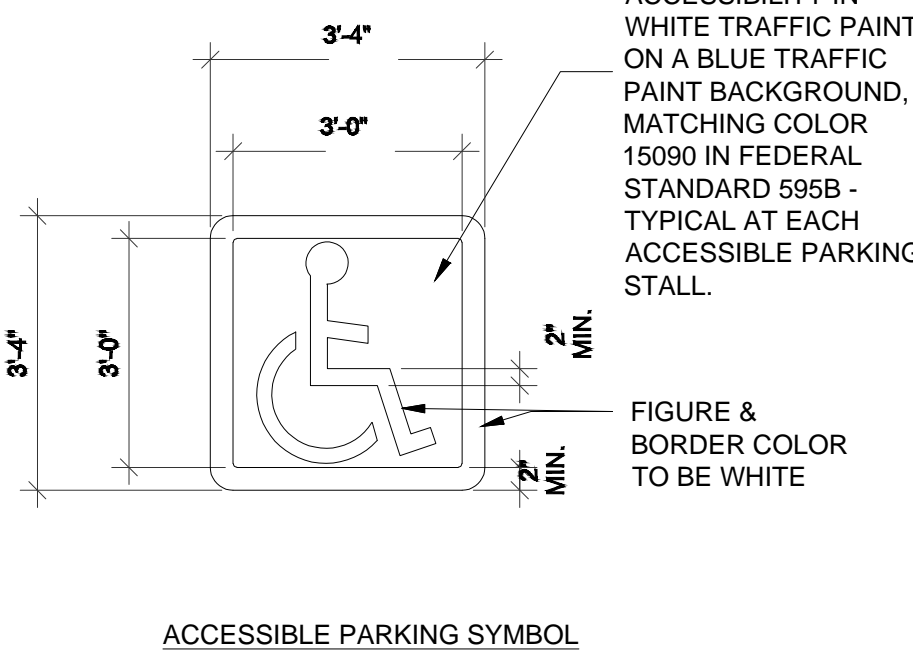

NOTES

1. A CONCRETE CUTTING SAW SHALL BE USED TO SAWCUT ALL EXISTING PAVEMENT ALONG LINES OF REMOVAL, WHERE NEW PAVEMENT IS TO ADJOIN EXISTING.
2. OVERLAP SEALER COAT A MINIMUM OF 12' BEYOND JOINT LINES, WHERE NEW PAVEMENT ABUTTS EXISTING.
3. ALL SURFACES SHALL PROVIDE POSITIVE DRAINAGE FREE FROM DEPRESSIONS AND SHALL BE FLOODED AS NECESSARY TO VERIFY DRAINAGE CHARACTERISTICS.
4. DUST SHALL BE CONTROLLED BY WATERING.
5. PATCH, REPAIR AND/OR RECONSTRUCT ALL DAMAGED AREAS OF EXISTING PAVING TO MATCH ADJACENT SURFACES.
6. REFER TO ELECTRICAL AND PLUMBING DRAWINGS PRIOR TO EXCAVATING, TRENCHING OR GRADING OPERATIONS. VERIFY LOCATIONS AND DEPTHS OF UTILITIES AND PROTECT THROUGH-OUT THE WORK.
7. SCORE CONCRETE WALKS AND RAMPS AS INDICATED. EQUAL SPACES BETWEEN EXPANSION JOINTS.
8. DOUBLE LINES ACROSS CONCRETE WALKS INDICATE EXPANSION JOINTS AT 20'-0\" O.C. MAXIMUM.
9. STRIPING AND LETTERING SHALL BE 2 COATS OF WHITE TRAFFIC PAINT APPLIED IN ACCORDANCE WITH MANUFACTURERS WRITTEN INSTRUCTIONS. ALL LETTERING TO BE 12\" HIGH WITH 1-1/2\" WIDE STROKE. ALL STRIPING 4\" WIDE. ALL STRIPING TO BE APPLIED WITH CUTOUTS AND TEMPLATES WITHOUT FUZZINESS OR WAVINESS.
10. SEE SITE PLAN FOR OVERALL LAYOUT.
11. THESE DETAILS ARE FOR REFERENCE AND DIMENSION CONTROL ONLY.
12. 8 ACCESS AISLE SHALL BE PLACED ON THE PASSENGER SIDE OF A VAN ACCESSIBLE SPACE.
13. ALL DIMENSIONS ARE TO CENTERLINE OF STRIPE UNLESS OTHERWISE INDICATED.
14. PARKING SPACE AND ACCESS AISLE SHALL HAVE A MAXIMUM SLOPE OF 1.5% IN ANY DIRECTION.
15. POLE SIGNAGE SHALL NOT BE PLACED IN A PATH OF TRAVEL.
16. IF POLE INSTALLED NEXT TO ACCESSIBLE WALKWAY PROVIDE 1'-0\" MIN. CLEAR.
17. PER CBC 11B-502.2 EXCEPTION: VAN PARKING SPACES SHALL BE PERMITTED TO BE 108 INCHES WIDE MINIMUM WHERE THE ACCESS AISLE IS 96 INCHES WIDE MINIMUM.

5 WALL & FENCE MOUNTING SIGN

Scale: 1\" = 1'-0"

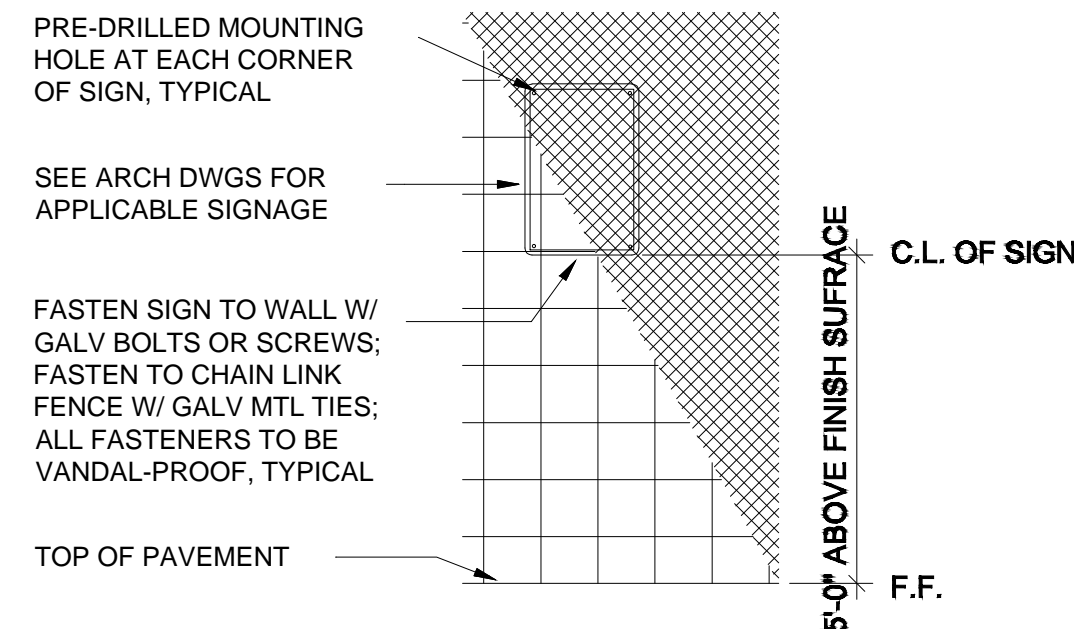

4 POST MOUNTED SIGN - FOOTING

Scale: 1\" = 1'-0"

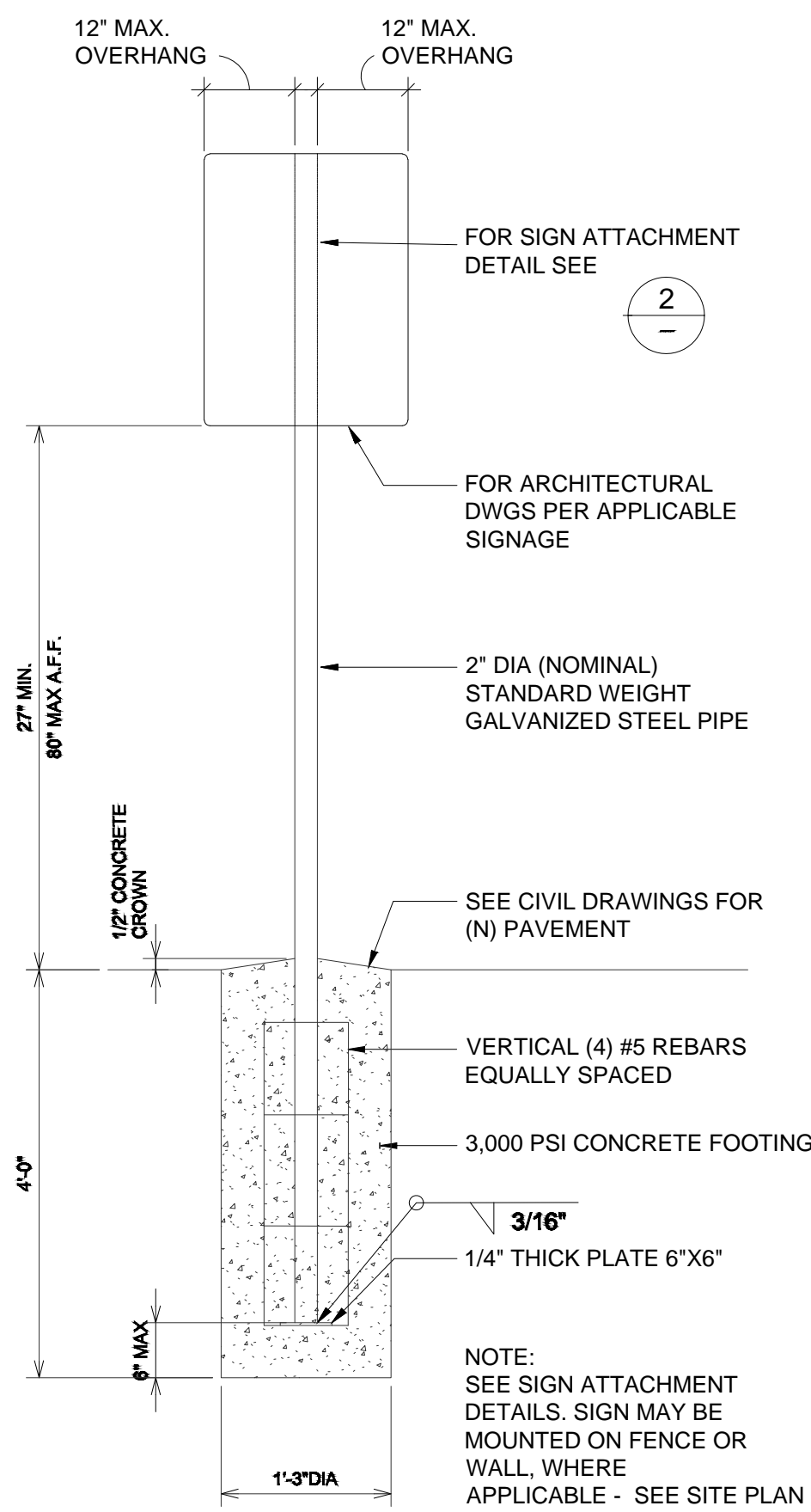

3 ACCESSIBLE DIRECTIONAL SIGNAGE

Scale: 3\" = 1'-0"

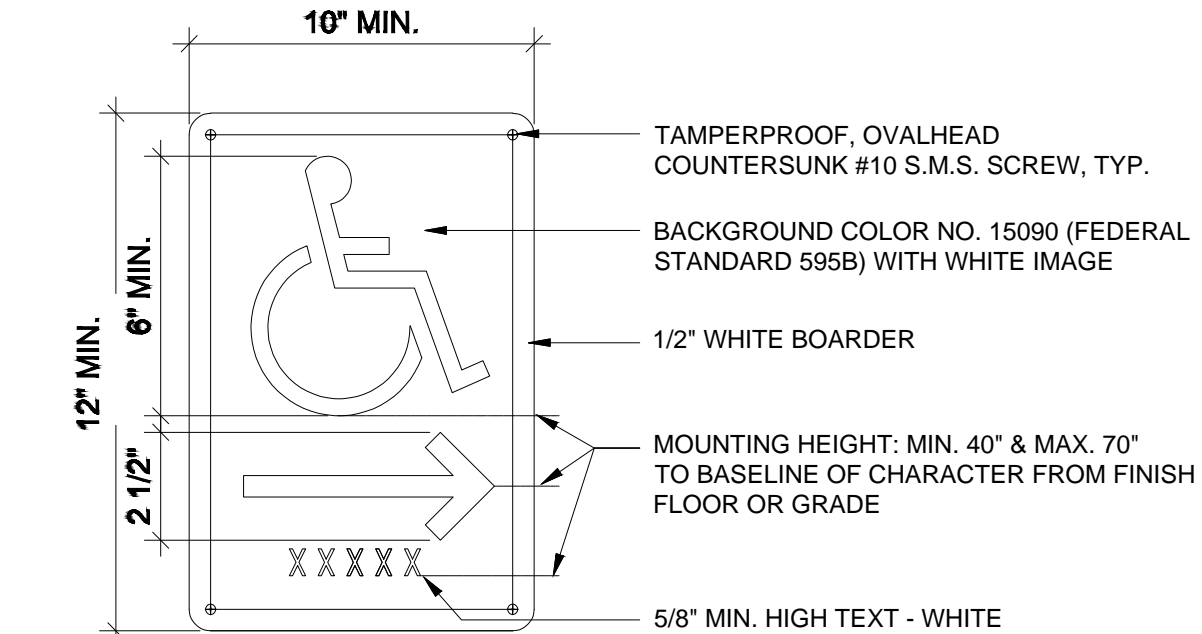

NOTE:
VISUAL CHARACTERS ON SIGNS SHALL BE SELECTED FROM FONTS WHERE THE WIDTH OF THE UPPERCASE LETTER 'O' IS 60 PERCENT MINIMUM AND 110 PERCENT MAXIMUM OF THE HEIGHT OF THE UPPERCASE LETTER 'I'. STROKE THICKNESS OF THE UPPERCASE LETTER 'I' SHALL BE 10 PERCENT MINIMUM AND 20 PERCENT MAXIMUM OF THE HEIGHT OF THE CHARACTER.

CHARACTER HEIGHT TO BE 5/8\" MIN. AND 2\" MAX BASED ON THE HEIGHT OF THE UPPERCASE 'I' CBC 11B-703.2.5

ISA (INTERNATIONAL SYMBOL OF ACCESSIBILITY) SHALL COMPLY WITH CBC 11B-703.7 AND CBC FIGURE 11B-703.7.2.1 (PROPORTIONS), TYP.

ACCESSIBLE DIRECTIONAL SIGN: COMPLY WITH VISUAL SIGN REQUIREMENTS (11B-703.5)

REFER TO SPEC 10 1400-2.3-B AND CBC 2016 11B-703.5 FOR REQUIREMENTS FOR VISUAL CHARACTER SIGNS.

FOR POST MOUNTED SIGNAGE SEE DETAIL 4/-

2 SIGN ATTACHMENT DETAIL - POST

Scale: 1\" = 1'-0"

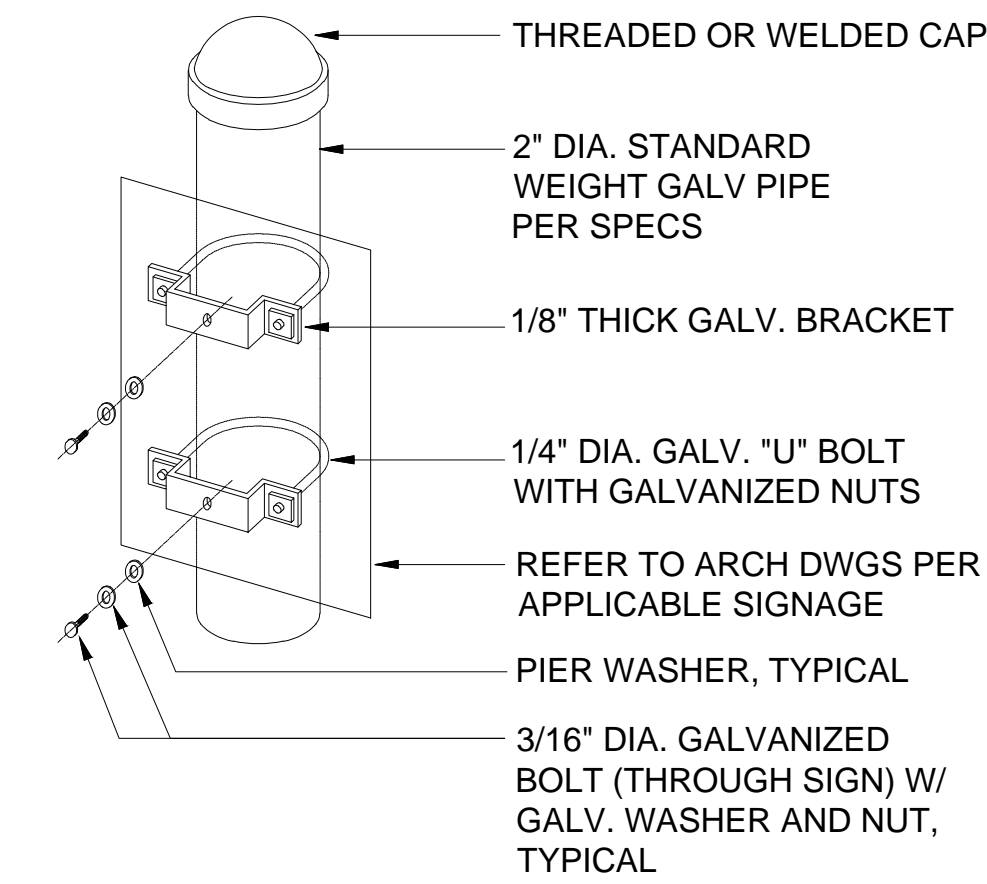

- NOTES:**
1. DETECTABLE WARNING TILE SHALL FORM CONTINUOUS SURFACE OF CROSSWALK.
 2. COLOR YELLOW TO MATCH FEDERAL COLOR NO. 33538, PER STANDARD NO. 595C.
 3. PROVIDE 5 YEAR PRODUCT WARRANTY PER DSA BULLETIN ISSUED 10/31/2002, REVISED 04/09/2008

WHERE THE DETECTABLE WARNING SURFACE DOES NOT PROVIDE A 70 PERCENTAGE MINIMUM CONTRAST WITH ADJACENT WALKING SURFACES, 1-INCH (25MM) WIDE MINIMUM VISUALLY CONTRASTING SURFACE SHALL SEPARATE THE DETECTABLE WARNING FROM ADJACENT WALKING SURFACES. YELLOW COLOR APPROX. FS 33538 OF FEDERAL STANDARD 595C.

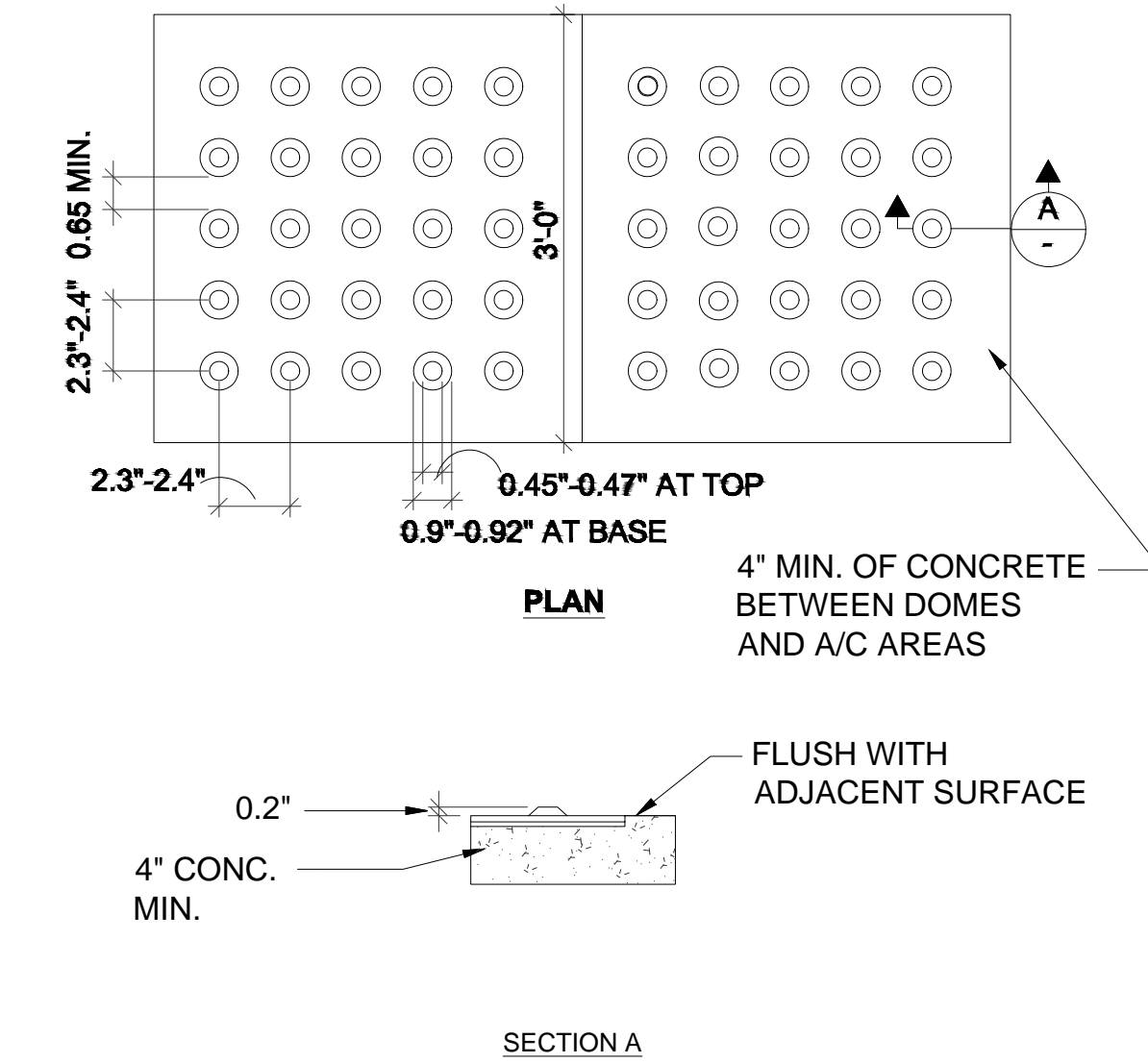

1 DETECTABLE WARNING DOMES

Scale: 3\" = 1'-0"

FILE No.: 19-91 AH: 03-123587

DESCRIPTION

DATE

REV.



DESIGNER, ARCHITECTS AND OTHER
USING THIS SEAL FOR ANY PROJECT
WITHIN THE PROJECT FOR WHICH THE
USE MUST BE IN ACCORDANCE WITH THE
STATE OF CALIFORNIA
THAN THE ONE FOR WHICH THEY ARE
REGISTERED, EXCEPT BY REPRESENTATION IN
WRITING.

ROSEMEAD SCHOOL DISTRICT
MILDRED B. JANSON ELEMENTARY SCHOOL
CONSTRUCTION OF NEW PLAYGROUNDS

8628 MARSHALL ST., ROSEMEAD, CA 91770

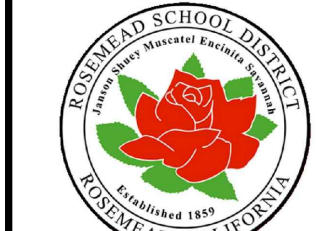

ROSEMEAD
SCHOOL DISTRICT
3807 ROSEMEAD BLVD.,
ROSEMEAD, CA 91770

NAC
ARCHITECTURE
nacarchitecture.com
837 N. Spring Street, Third Floor
Los Angeles, CA 90012-2323
P:323.475.8075

NAC NO 161-23078
DRAWN AF
CHECKED MO,GC
DATE 08/30/2023

DETAILS

© 2021 NAC Inc

A8.01

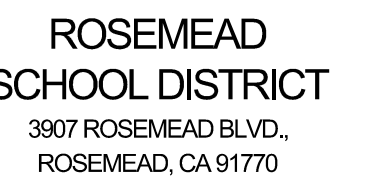
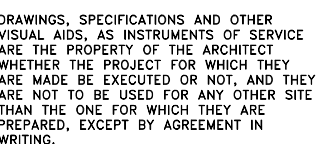

NAC NO 161-23078
DRAWN AF
CHECKED MO,GC
DATE 08/30/2023

A8.02

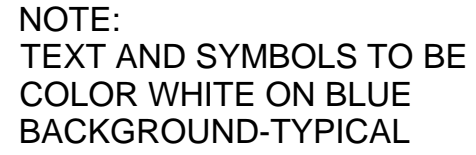

Scale: 1'-0" = 1'-0"

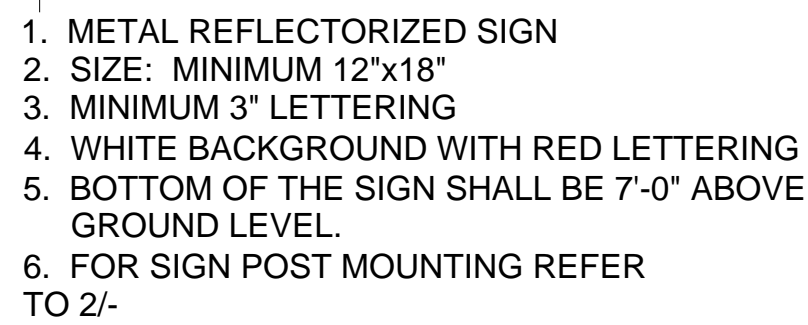

Scale: $3/16" = 1'-0"$

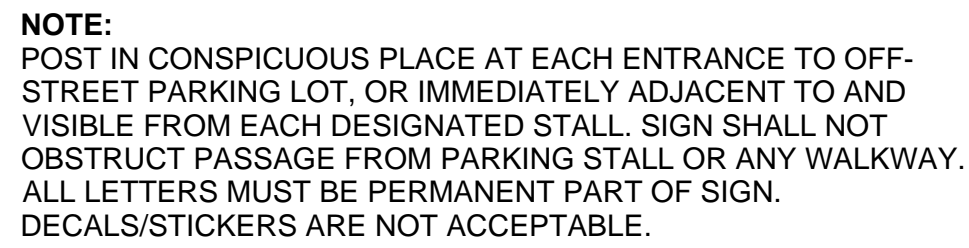

Scale: 1 1/2" = 1'-0"



Scale: 1" = 1'-0"

-
- PRE-DRILLED MOUNTING HOLE AT EACH CORNER OF SIGN, TYPICAL
- SEE ARCH DWGS FOR APPLICABLE SIGNAGE
- FASTEN SIGN TO WALL W/ GALV BOLTS OR SCREWS; FASTEN TO CHAIN LINK FENCE W/ GALV MTL TIES; ALL FASTENERS TO BE VANDAL-PROOF, TYPICAL
- TOP OF PAVEMENT
- C.L. OF SIGN
- 6'-0" ABOVE FINISH SURFACE
- F.F.

Scale: 1" = 1'-0"

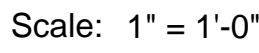
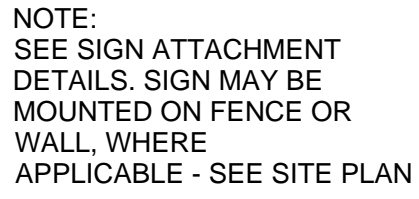

Scale: 1" = 1'-0"

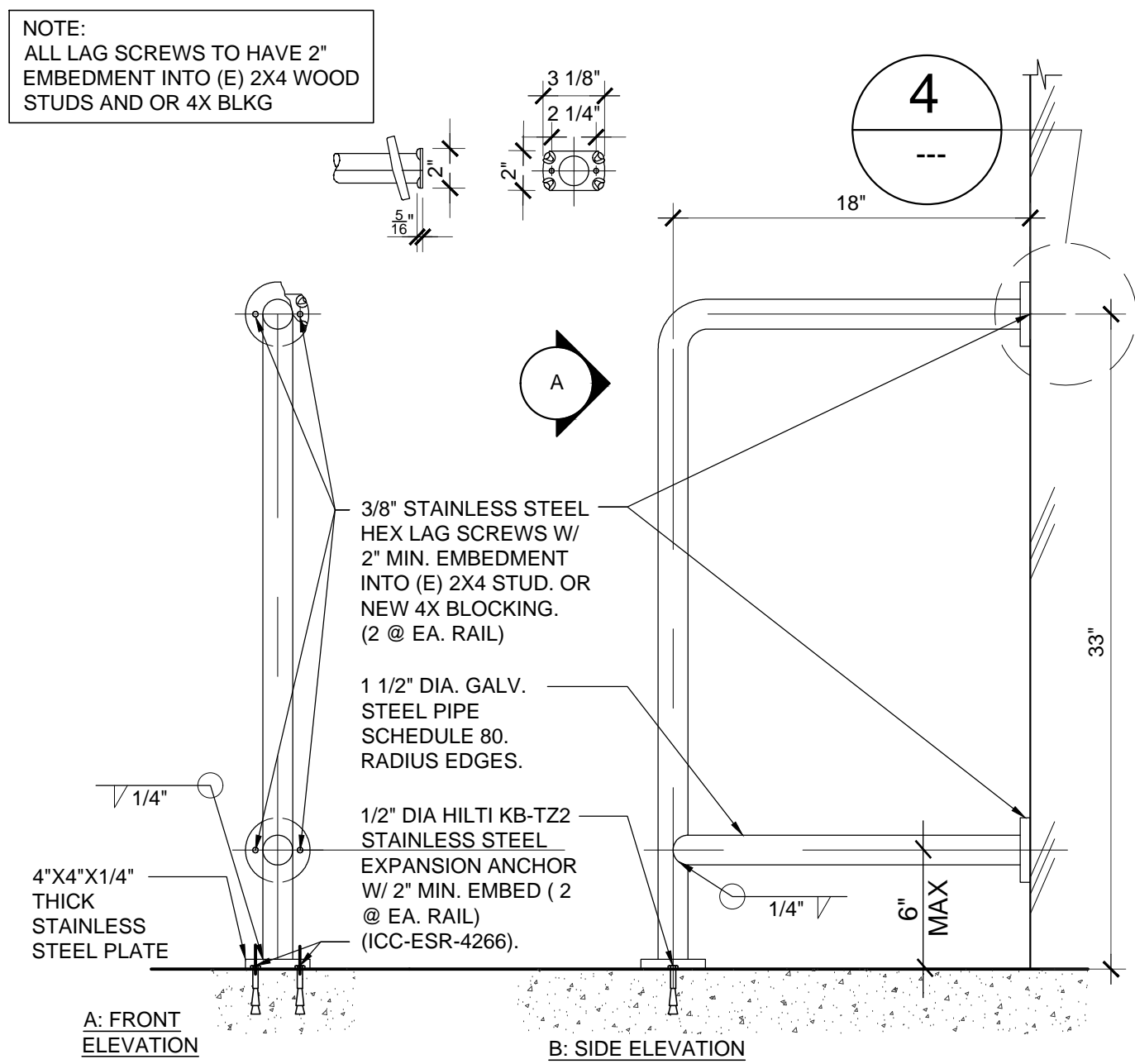

3 DRINKING FOUNTAIN GUARDRAILS
SCALE: 1-1/2" = 1'-0"

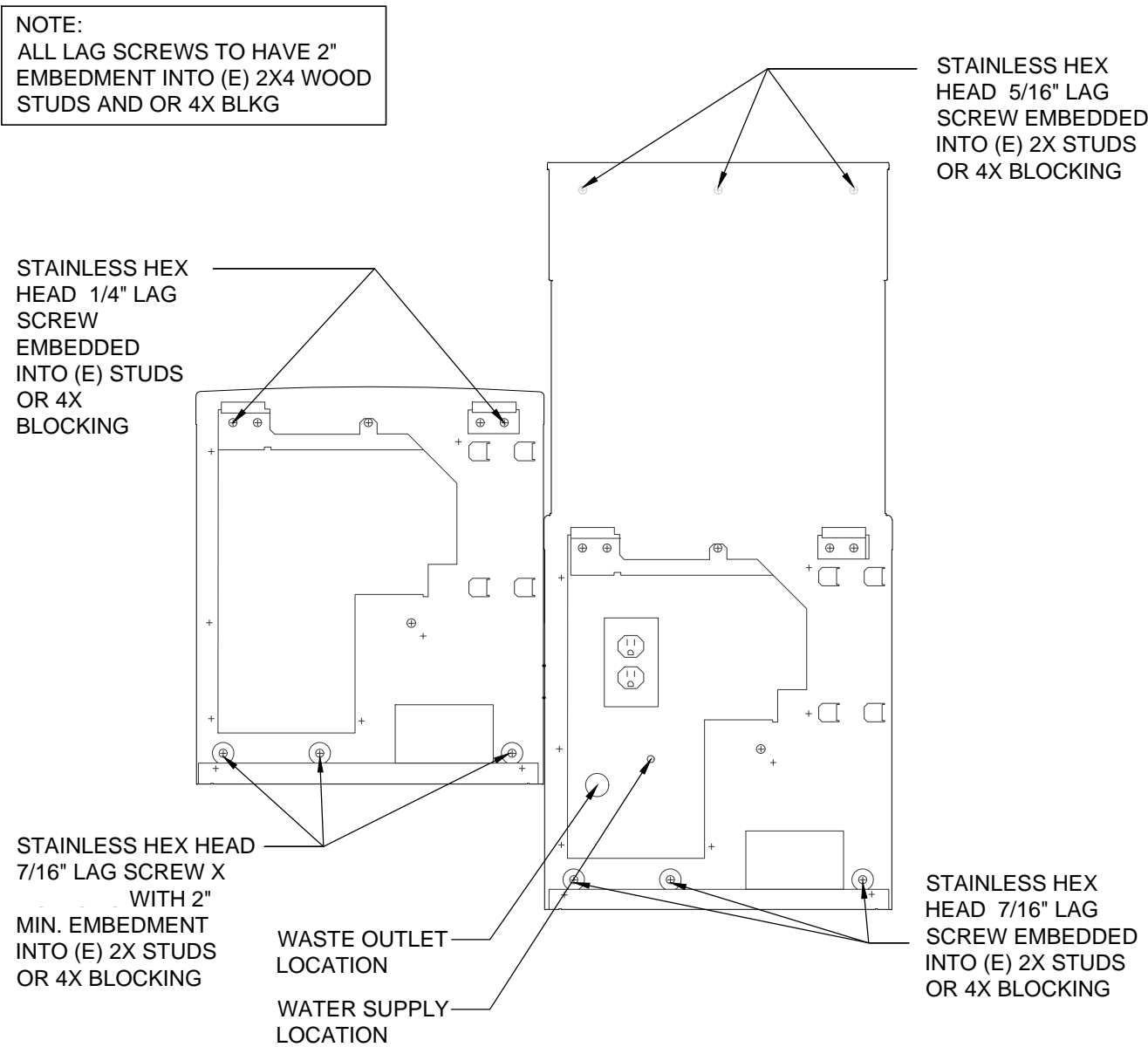

2 DRINKING FOUNTAIN ANCHORAGE
SCALE: 1-1/2" = 1'-0"

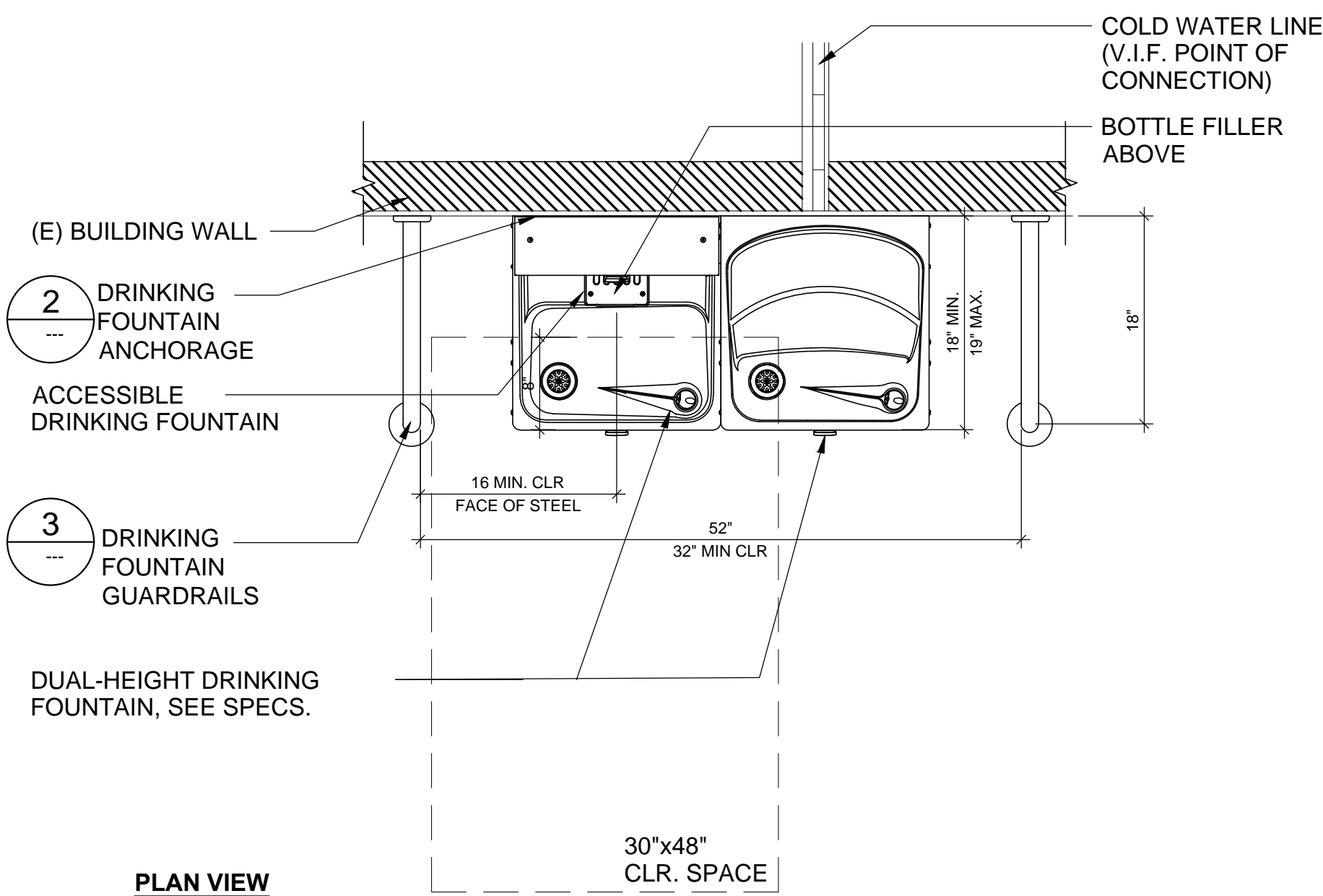

PLAN VIEW

ACCESSIBLE DUAL-HEIGHT DRINKING FOUNTAIN NOTES:

1. SEE SPECIFICATIONS FOR ADDITIONAL INFORMATION.
2. REFER TO WALL TYPE PER ARCHITECTURAL PLANS.
3. REFER TO TITLE 24, CCR TABLE FOR HIGH SCHOOL ACCESSIBLE DIMENSION REQUIREMENTS.
4. GRIND SMOOTH ALL WELD AND GALV. METAL AFTER FABRICATION.
5. FABRICATION OF PROTECTIVE WING WALL/RAILINGS SHALL BE PERFORMED IN CONFORMANCE TO C.B.C.-TITLE 24 REQUIREMENT, THE AMERICAN WELDING SOCIETY (A.W.S.) AND THE STRUCTURAL WELDING CODE.
6. SHOP DRAWINGS SHALL BE SUBMITTED FOR REVIEW PRIOR TO ANY FABRICATION.
7. FABRICATION SHALL BE PERFORMED IN AN APPROVED SHOP.
8. ALL WELDING SHALL BE PERFORMED BY AN AWS CERTIFIED WELDER. NO FIELD WELDING SHALL BE ALLOWED.
9. THE SPOUT SHALL PROVIDE A FLOW OF WATER AT LEAST 4 INCHES (102MM) HIGH MINIMUM AND SHALL BE LOCATED 5 INCHES (127MM) MAXIMUM FROM THE FRONT OF THE UNIT. THE ANGLE OF THE WATER SHALL BE MEASURED HORIZONTALLY RELATIVE TO THE FRONT FACE OF THE UNIT. WHERE SPOUTS ARE LOCATED LESS THAN 3 INCHES (76MM) OF THE FRONT OF THE UNIT, THE ANGLE OF THE WATER STREAM SHALL BE 30 DEGREES MAXIMUM. WHERE SPOUTS ARE LOCATED BETWEEN 3 INCHES (76MM) AND 5 INCHES (127 MM) MAXIMUM FROM THE FRONT OF THE UNIT, THE ANGLE OF THE WATER STREAM SHALL BE 15 DEGREES MAXIMUM. ON AN ACCESSIBLE DRINKING FOUNTAIN WITH A ROUND OR OVAL BOWL, THE SPOUT MUST BE POSITIONED SO THE FLOW OF WATER IS WITHIN 3 INCHES (75MM) OF THE FRONT EDGE OF THE FOUNTAIN

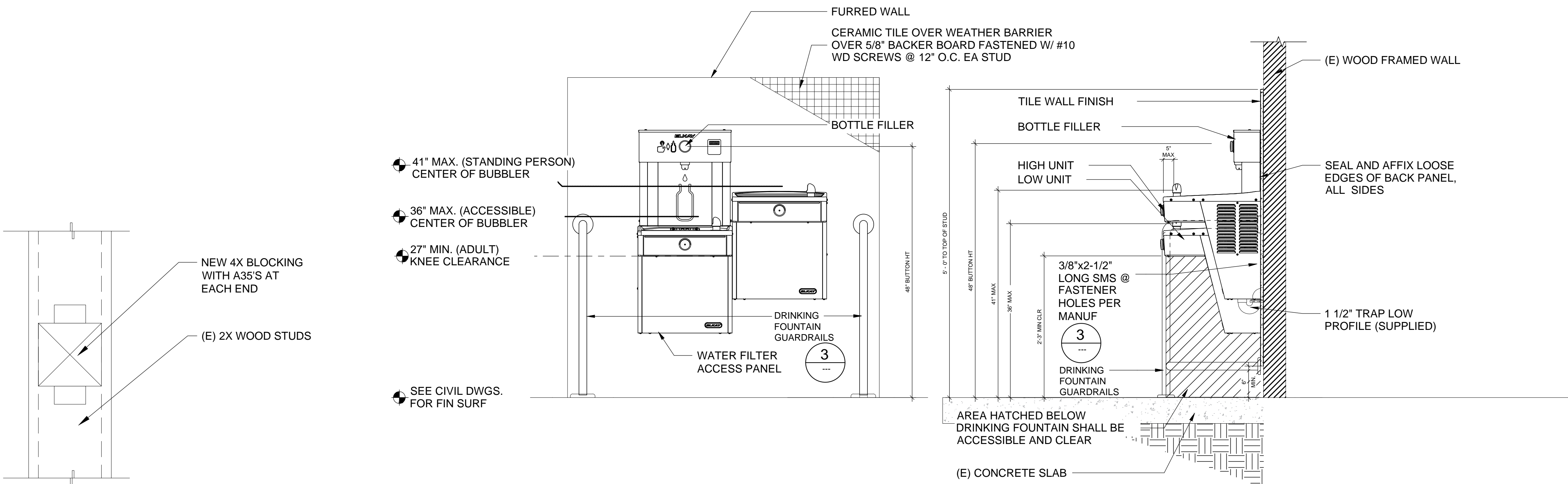

ELEVATION

SECTION

4 BACKING SECTION, TYP.
Scale: 3" = 1'-0"

1 INTERIOR DUAL HT DRINKING FOUNTAIN - CONCRETE
Scale: 1" = 1'-0"

DESCRIPTION
DATE
REV.

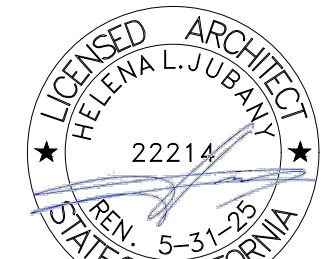

DRAWN, SPECIFICATIONS AND OTHER
VIEWS, AND, AS INSTRUMENTS OF SERVICE
AND THE PROPERTY OF THE ARCHITECT.
THESE DRAWINGS ARE TO BE USED ONLY
FOR THE PROJECT FOR WHICH THEY
WAS MADE. NO EXCISES OR MOD. AND THEY
SHALL BE THE ONLY SET FOR ANY CONSTRUCTION.
EXCEPT BY AGREEMENT IN WRITING.

ROSEMEAD SCHOOL DISTRICT
MILDRED B. JANSON ELEMENTARY SCHOOL
CONSTRUCTION OF NEW PLAYGROUNDS
8628 MARSHALL ST., ROSEMEAD, CA 91770



ROSEMEAD
SCHOOL DISTRICT
3807 ROSEMEAD BLVD.,
ROSEMEAD, CA 91770

NAC
ARCHITECTURE
nacarchitecture.com
8574 Spring Street, Third Floor
Los Angeles, CA 90012-2323
P: 323.475.8075

NAC NO: 161-23078
DRAWN: AF
CHECKED: MO,GC
DATE: 08/30/2023

DRINKING
FOUNTAIN DETAILS

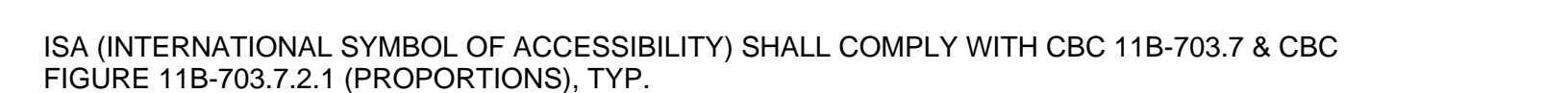

Scale: 6" = 1'-0"

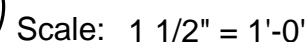

Scale: $1/2" = 1'-0"$

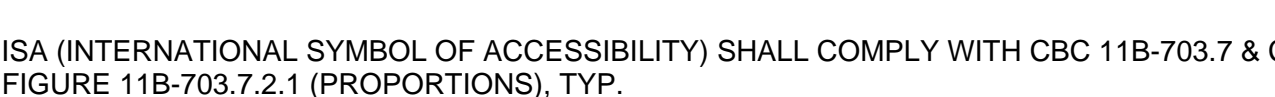

Scale: NTS

$$: 6'' = 1'-0''$$

11B-703.4 INSTALLATION HEIGHT AND LOCATION

SIGNS WITH TACTILE CHARACTERS SHALL COMPLY WITH SECTION 11B-703.4.

11B-703.4.1 HEIGHT ABOVE FINISH FLOOR OR GROUND. TACTILE CHARACTERS ON SIGNS SHALL BE LOCATED 48" MIN. ABOVE THE FINISH FLOOR OR GROUND SURFACE MEASURED FROM THE BASELINE OF THE SIGN TO THE BOTTOM CELL OF THE TACTILE CHARACTERS. THE HIGHEST OR GROUND SURFACE MEASURED FROM THE BASELINE OF THE FLOOR OF THE SIGNS CHARACTERS.

EXCEPTION, TACTILE CHARACTERS FOR ELEVATOR CAR CONTROLS SHALL NOT BE REQUIRED TO COMPLY WITH SECTION 11B-703.4.1.

11B-703.4.2 LOCATION. WHERE A TACTILE SIGN IS PROVIDED AT A DOOR, THE SIGN SHALL BE LOCATED TO THE RIGHT OF THE DOOR. WHERE A TACTILE SIGN IS PROVIDED AT DOUBLE DOORS WITH ONE ACTIVE LEAF, WHERE A TACTILE SIGN IS PROVIDED AT DOUBLE DOORS WITH TWO ACTIVE LEAFS, THE SIGN SHALL BE LOCATED TO THE RIGHT OF THE RIGHT HAND DOOR. WHERE THERE IS NO SPACE TO THE RIGHT OF THE DOOR, THE SIGN SHALL BE LOCATED TO THE LEFT OF DOUBLE DOORS, SIGNS SHALL BE LOCATED ON THE NEAREST ADJACENT WALL OR CONTAINMENT. SIGNS CONTAINING TACTILE CHARACTERS SHALL BE LOCATED AT A CLEAR FLOOR SPACE OF 18" MIN. BY 18" MIN. CENTERED ON THE DOOR. THE SIGN SHALL BE LOCATED AT LEAST 45 DEGREE ANGLE OPEN POSITION. WHERE PROVIDED, SIGNS IDENTIFYING PERMANENT ROOMS AND SPACES SHALL BE LOCATED TO THE EXTERIOR OF THE ROOM OR SPACE. WHERE PROVIDED, SIGNS IDENTIFYING EXITS SHALL BE LOCATED AT THE EXIT DOOR. WHERE APPROVED BY THE AIA, SIGNS IDENTIFYING ROOMS AND SPACES SHALL BE PERMITTED ON ALTERNATIONS WHERE SIGN INSTALLATION LOCATIONS IDENTIFIED IN SECTION 11B-703.2 ARE OBSTRUCTED OR OTHERWISE NOT FEASIBLE FOR SIGN INSTALLATION. SIGNS WITH TACTILE CHARACTERS SHALL BE PERMITTED ON THE PUSH SIDE OF DOORS WITH CLOSERS AND WITH DOORS WITHOUT CLOSERS.

WORK EXEMPT FROM DSA REQUIREMENTS FOR STRUCTURAL TESTS/SPECIAL INSPECTIONS:

CONCRETE:

CONCRETE BATCH PLANT INSPECTION IS NOT REQUIRED FOR ITEMS GIVEN IN CBC SECTION 1705 A 3.3.2 SUBJECT TO THE REQUIREMENTS AND LIMITATIONS IN THAT SECTION

TESTING OF REINFORCING BARS IS NOT REQUIRED FOR ITEMS GIVEN IN CBC SECTIONS 1910 A.2 SUBJECT TO REQUIREMENTS AND LIMITATIONS IN THAT SECTION

WELDING:

SOLID CLAD AND OPEN MESH FENCES, GATES AND MAX LEAF SPAN OF 10' AND GATES WITH A MAXIMUM ROLLING SECTION OF 10' ALL HAVING AN APEX HEIGHT LESS THAN 8' ABOVE LOWEST ADJACENT GRADE. WHEN LOCATED ABOVE CIRCULATION OR OCCUPIED SPACE BELOW, THESE GATES/FENCES ARE NOT LOCATED WITHIN 1.5 X GATE/FENCE HEIGHT (MAX. 8') TO THE EDGE OF FLOOR OR ROOF.

GENERAL ACCESSIBLE GATE NOTES:

- GATES IN THE PATH OF TRAVEL SHALL BE PROVIDED WITH A SOLID KICK PLATE, 10" HIGH AND 3" MAX. FROM THE PAVEMENT ON BOTH SIDES.
- MAXIMUM EFFORT TO OPERATE DOORS SHALL NOT EXCEED 5 LBS., SUCH PULL OR PUSH EFFORT BEING APPLIED AT RIGHT ANGLE.
- THE SWEEP PERIOD OF CLOSER SHALL BE ADJUSTED SO THAT FROM AN OPEN POSITION OF 70 DEGREES, THE DOOR WILL TAKE AT LEAST 3 SECONDS TO MOVE TO A POINT 3" FROM THE LATCH, MEASURED TO THE LEADING EDGE OF THE DOOR.
- GATE HARDWARE:
 - EXIT DEVICE: WITH PULL HANDLE TRIM, NIGHT LATCH FUNCTION VON DUPRIN AX-99-99 L-06, WHERE OCCURS SEE GATE SCHEDULE
 - DOOR CLOSER @ 7'-0" H.: 180-DEGREE, DELAYED ACTION L.C.N., 4041: NORTON PR7500DA, OR EQUAL
 - WELDABLE GATE BOX: K-BXMOR1-2, BY KEEDEX INC.
 - BALL BEARING HINGES: LOCHIX MAMMOTH HD-9005
- SEE SPECIFICATIONS FOR ADDITIONAL INFORMATION.

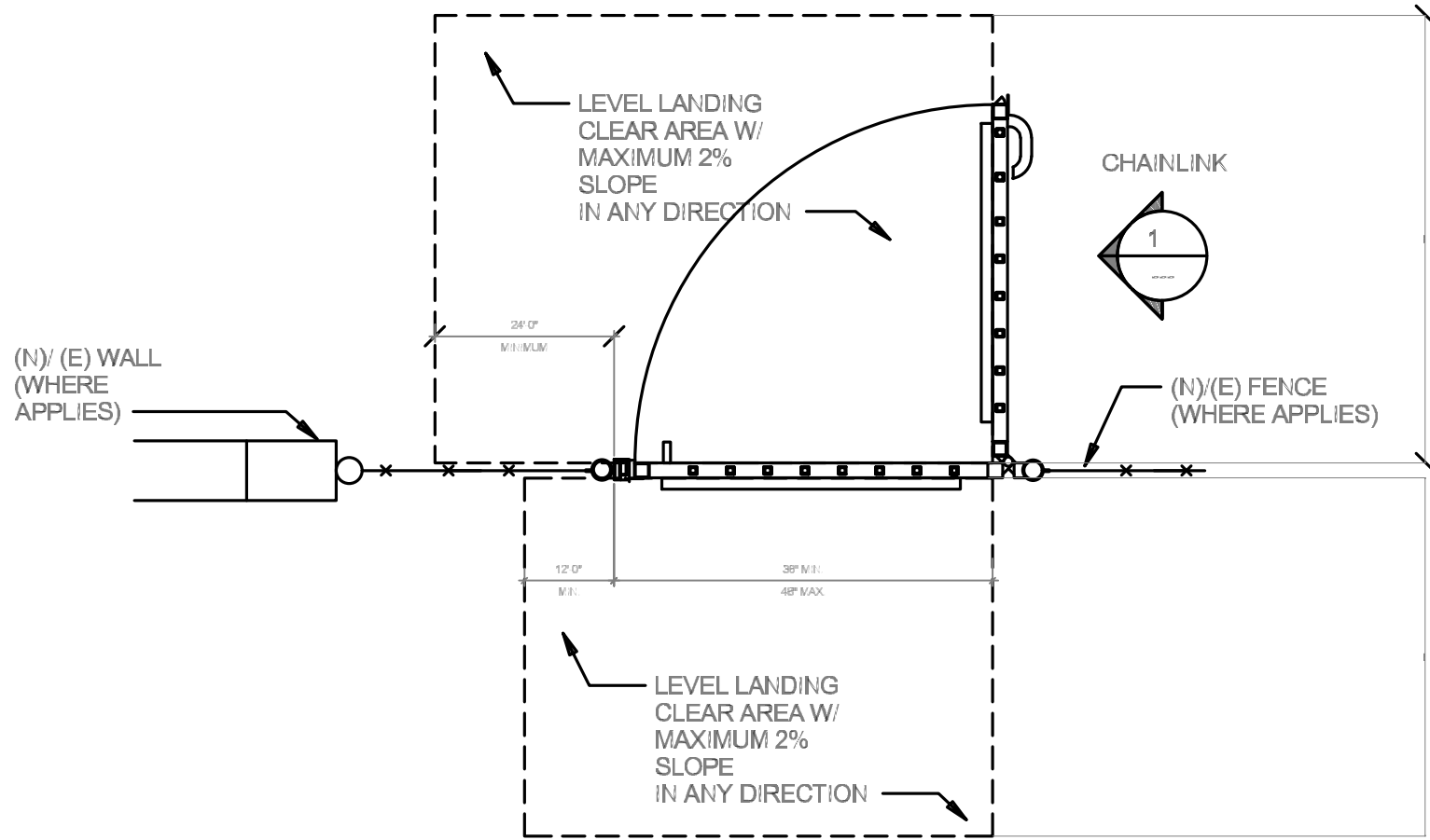

6 SL - GATE LANDING CLEARANCE AND NOTES
Scale: 1/2" = 1'-0"

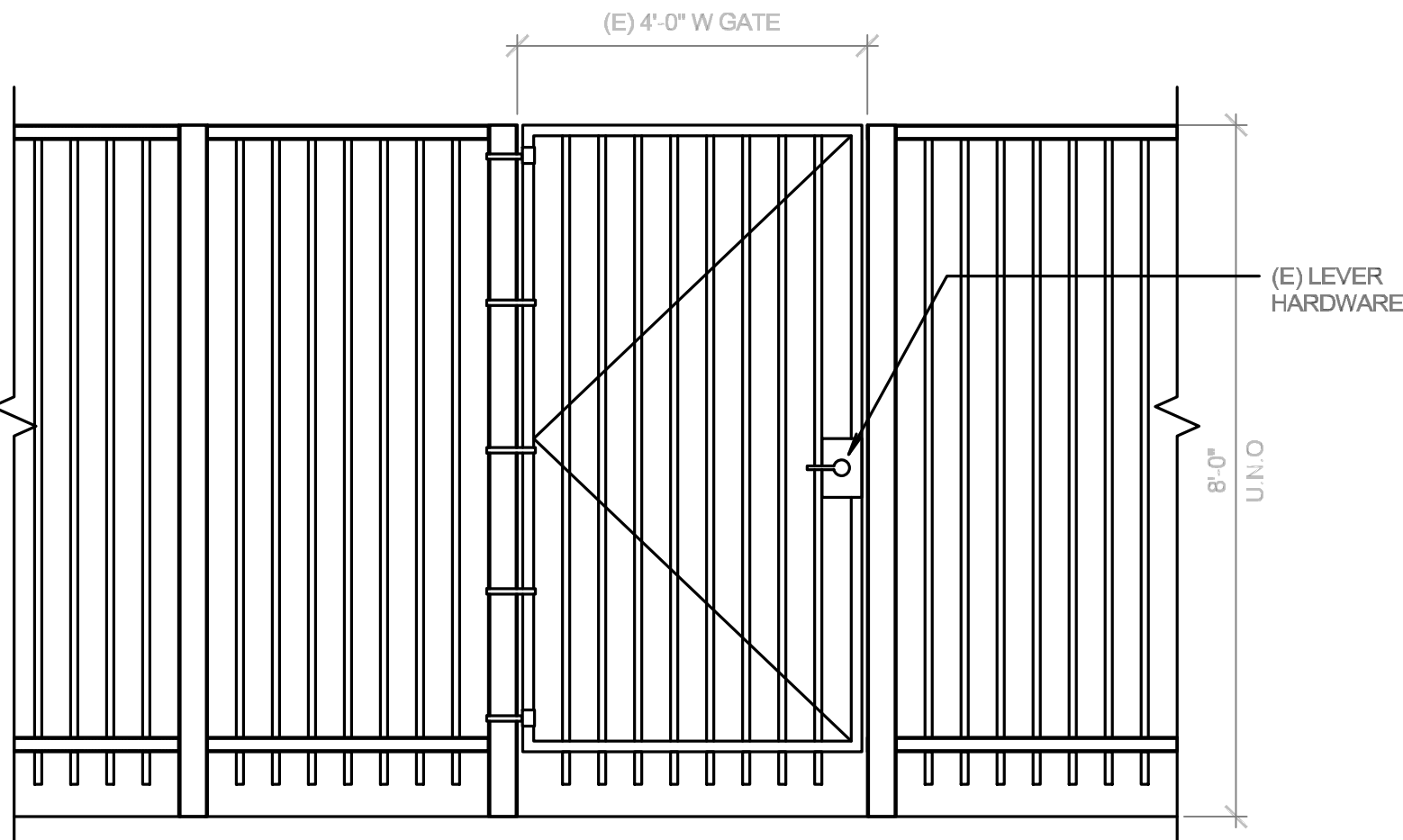

5 (E) WROUGHT IRON GATE
Scale: 1/2" = 1'-0"

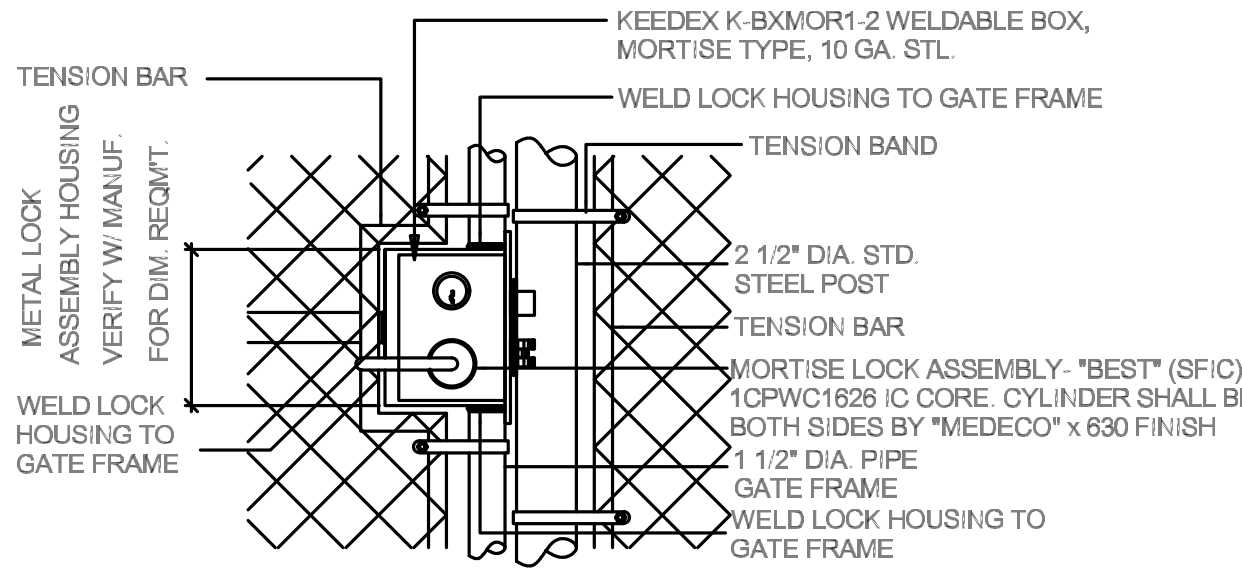

4 METAL LOCK ASSEMBLY
Scale: 1 1/2" = 1'-0"

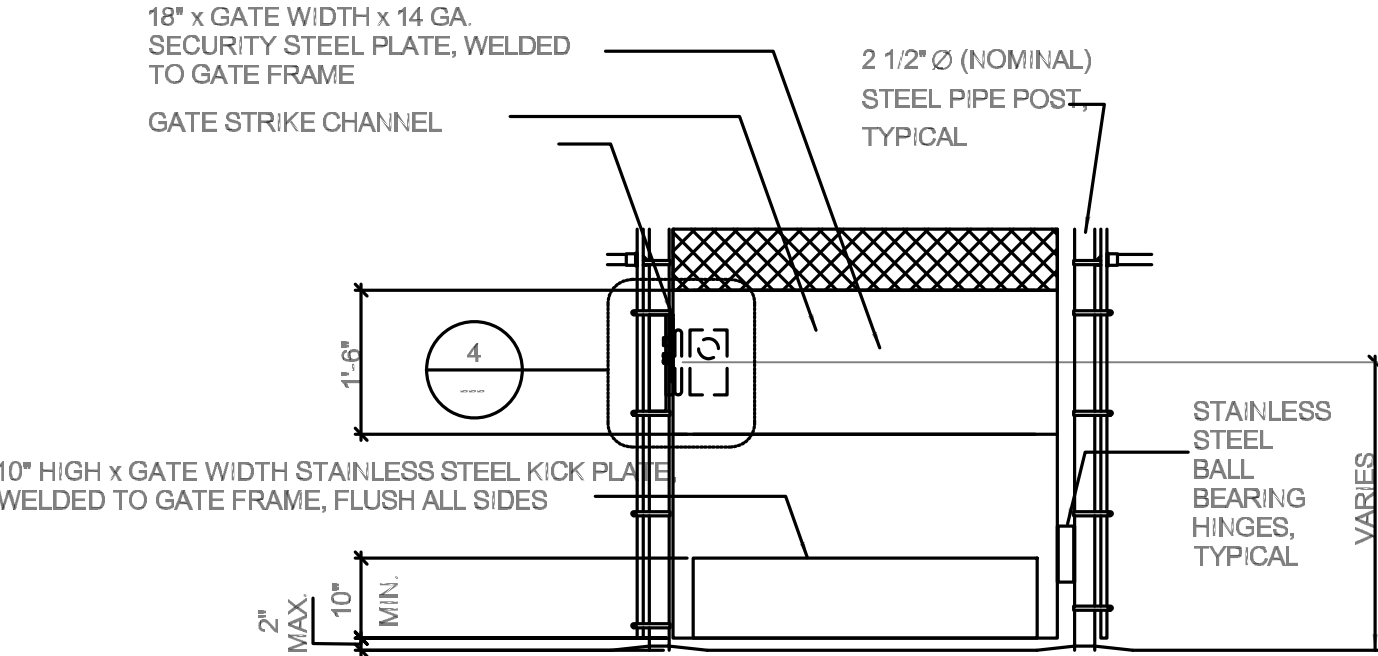

3 CHAINLINK GATE - ACCESSORIES
Scale: 1/2" = 1'-0"

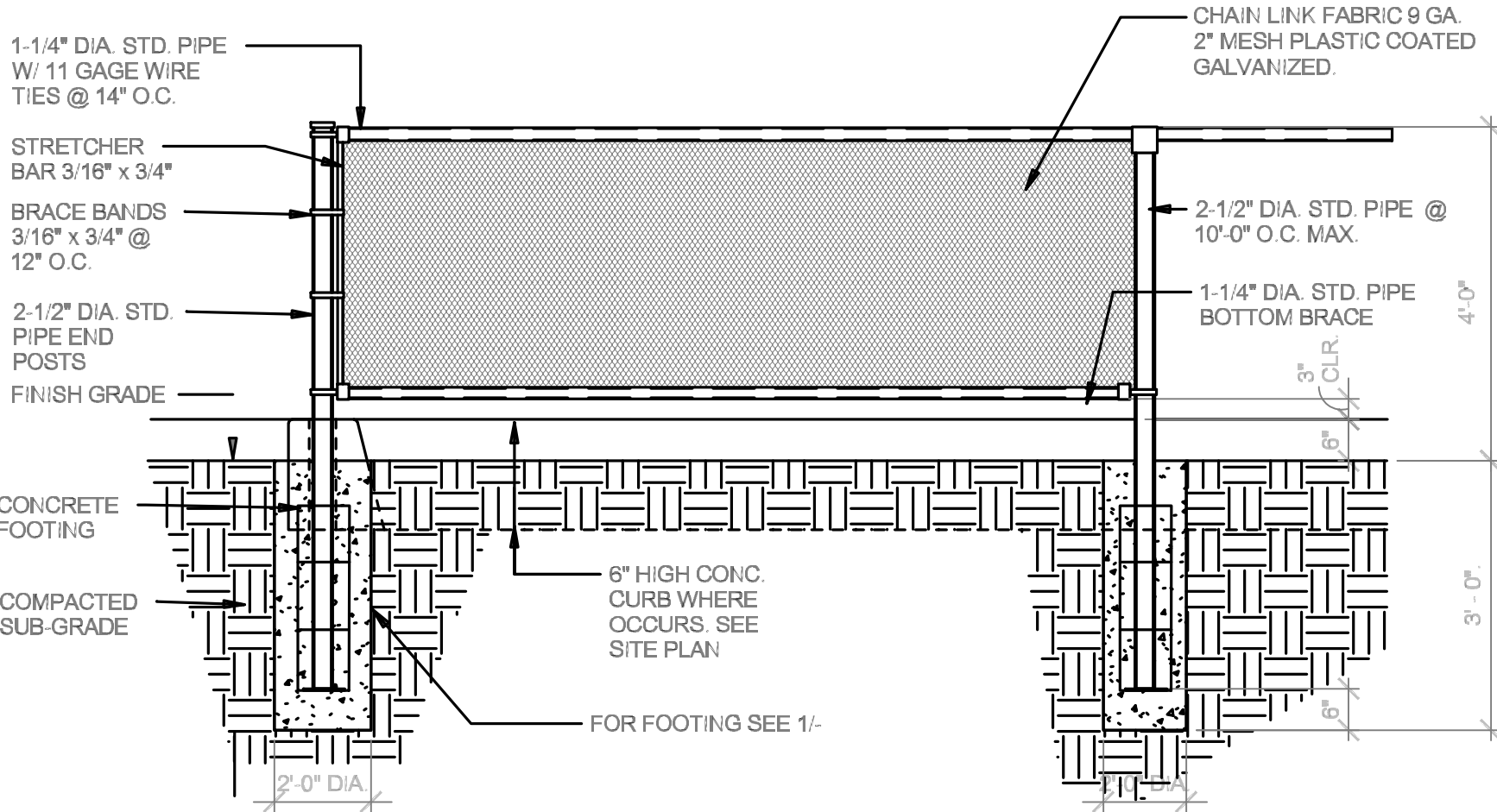

2 CHAIN LINK FENCE ELEVATION, TYP.
Scale: 1/2" = 1'-0"

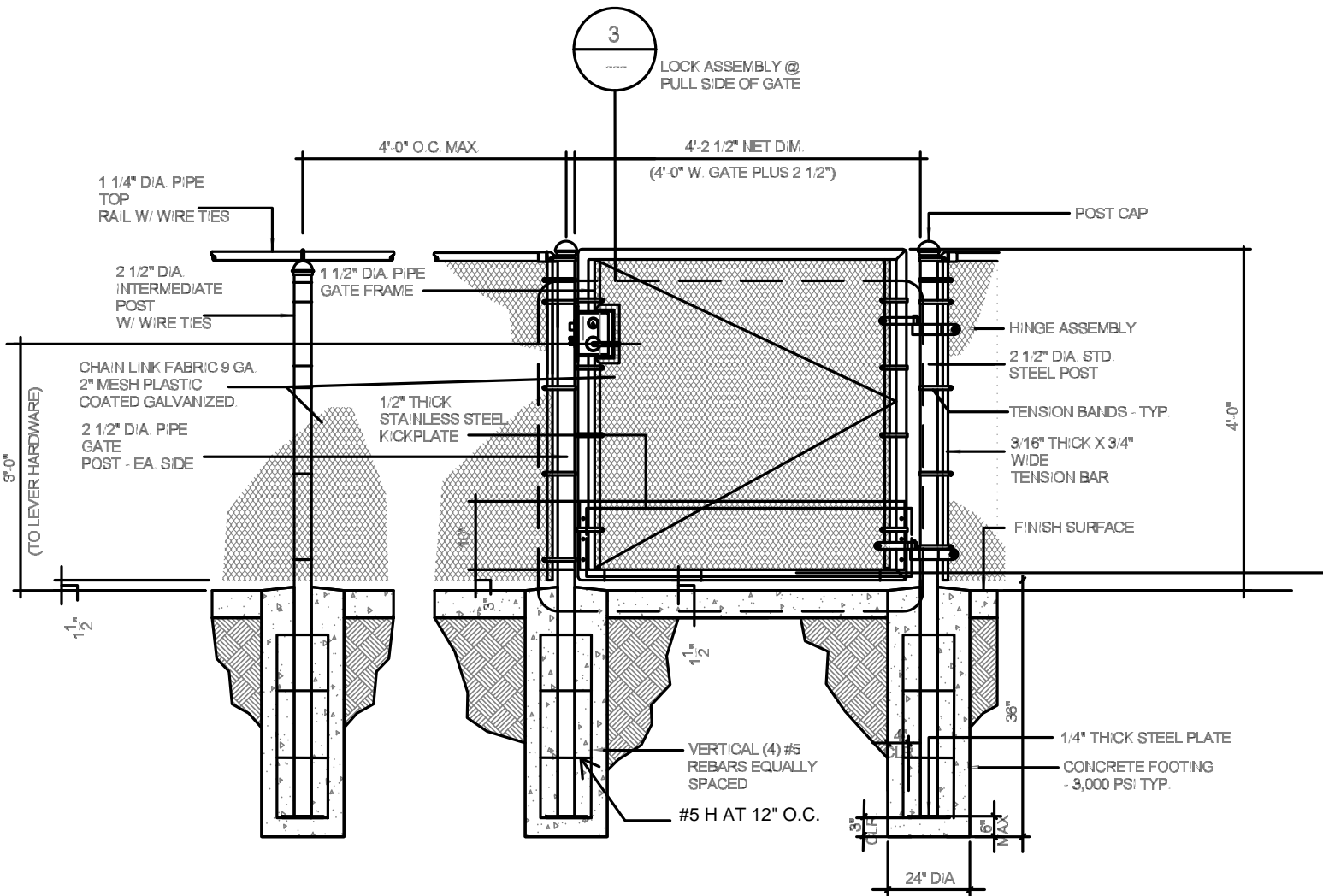

1 ACCESSIBLE CHAINLINK GATE
Scale: 1/2" = 1'-0"

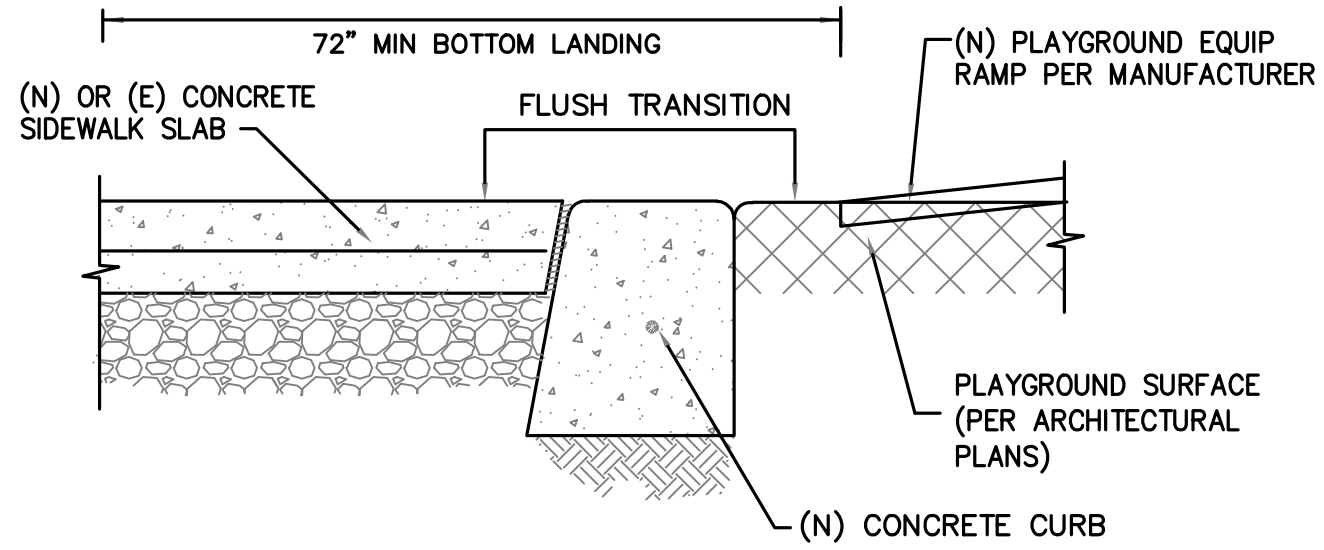

NOTE:
SEE DETAIL C/A8.01 FOR BALANCE OF INFORMATION

FLUSH CURB DETAIL AT LANDING
SCALE: NO SCALE D

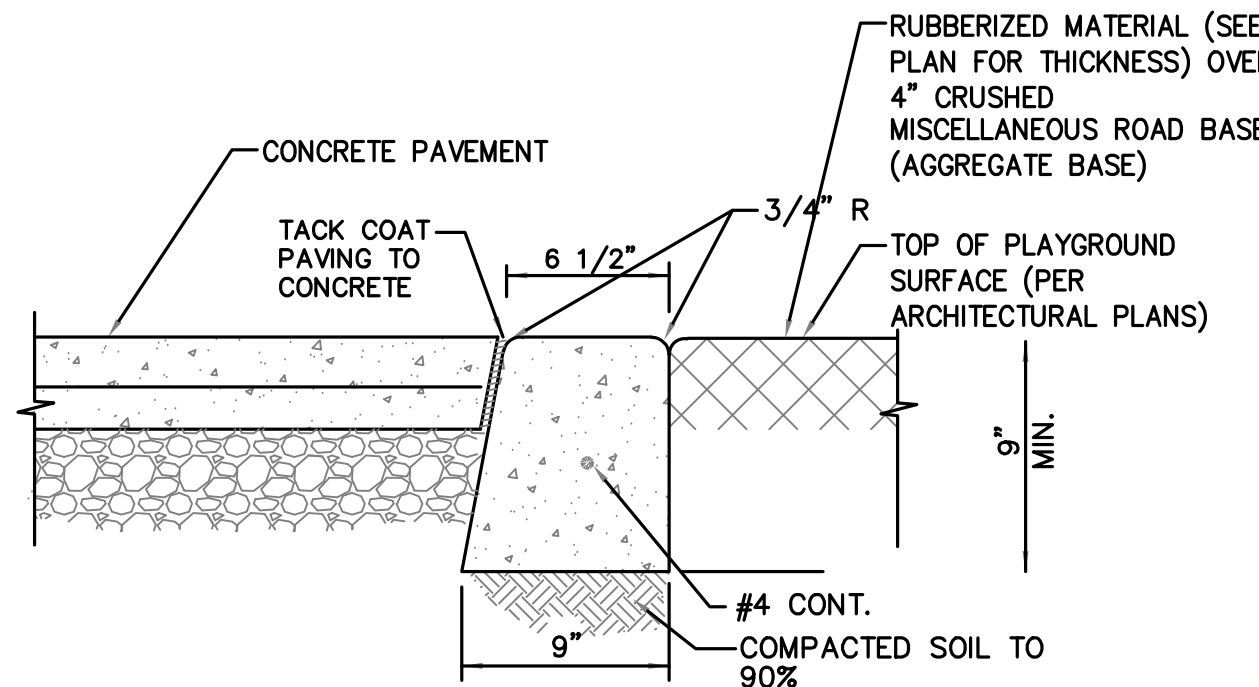

FLUSH CURB DETAIL AT CONC.
SCALE: NO SCALE C

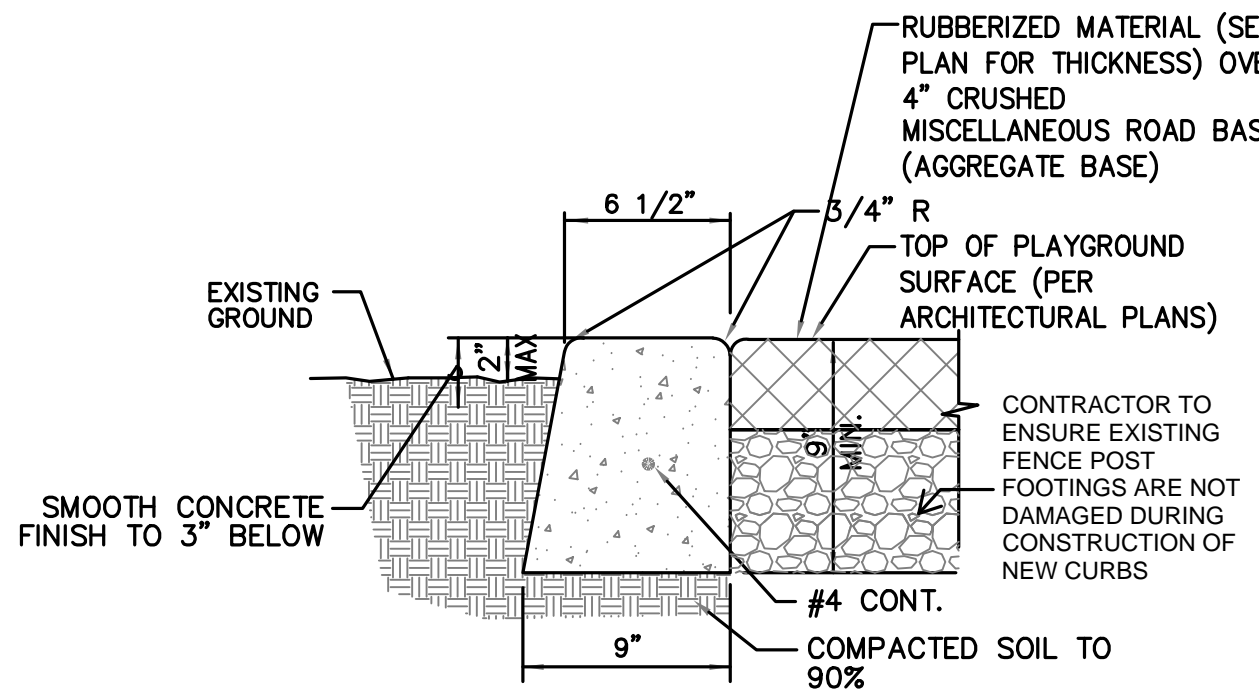

FLUSH CURB DETAIL AT (E) GROUND
SCALE: NO SCALE B

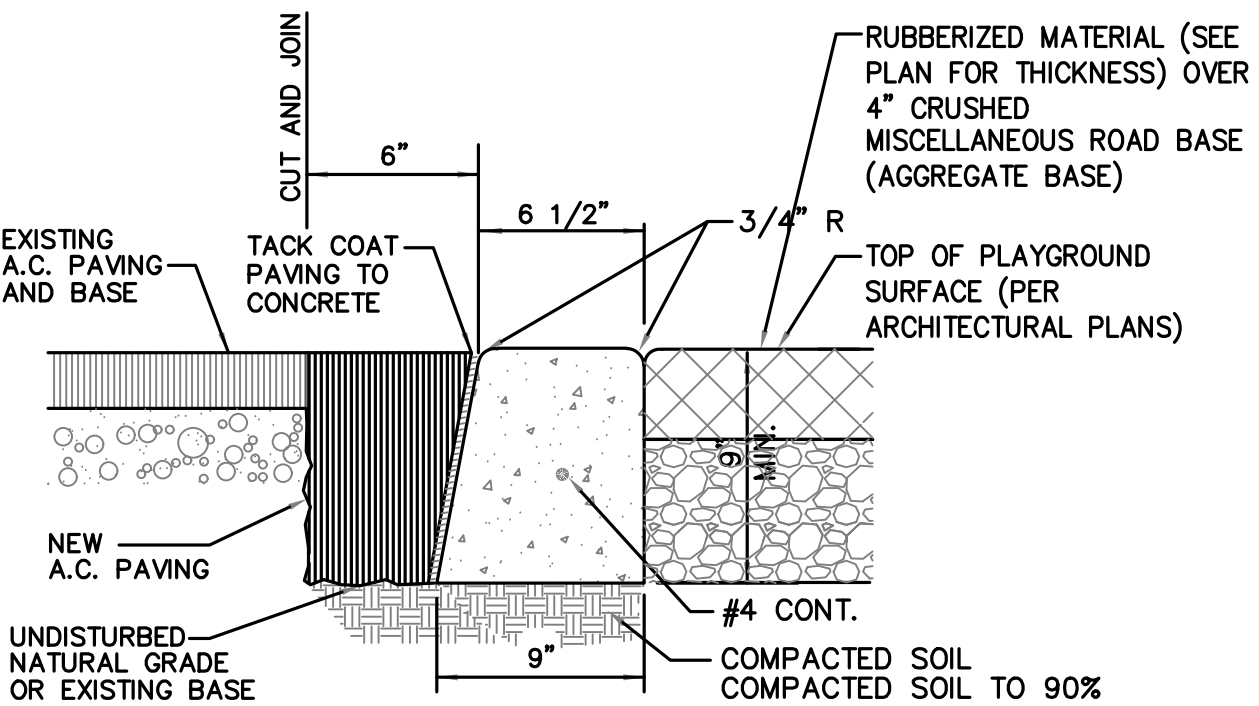

NOTES: (TYPICAL @ ALL SIMILAR CONDITIONS)

- BOTTOM OF CURB TO BE SET ON SUBGRADE SOIL COMPACTED TO 95% STANDARD PROCTOR.
- FINISH ALL EXPOSED CONCRETE SURFACES SMOOTH.
- PROVIDE 1/2" EXPANSION JOINTS AT 25'-0" O.C. MAX. AND AT CURVES, TANGENTS AND CORNERS.
- PORTLAND CEMENT CONCRETE, $f_c = 3500$ psi

FLUSH CURB DETAIL AT (E) AC PAV.
SCALE: NO SCALE A

FILE No.: 19-91 A#: 03-123587

DESCRIPTION
DATE
REV.

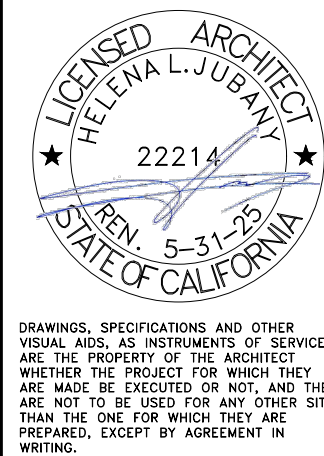

ROSEMEAD SCHOOL DISTRICT
MILDRED B. JANSON ELEMENTARY SCHOOL
CONSTRUCTION OF NEW PLAYGROUNDS
8628 MARSHALL ST., ROSEMEAD, CA 91770

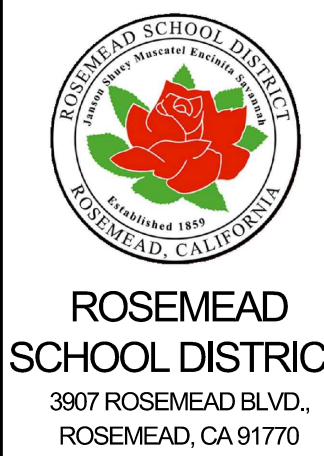

ROSEMEAD
SCHOOL DISTRICT
3907 ROSEMEAD BLVD.,
ROSEMEAD, CA 91770
NAC
ARCHITECTURE
nacarchitecture.com
817 N. Spring Street, Third Floor
Los Angeles, CA 90012-2323
P: 323.475.8075

NAC NO. 161-23078
DRAWN: AF
CHECKED: MO, GC
DATE: 08/30/2023

SITE DETAILS

A8.05

GENERAL NOTES:

1. ALL WORK DETAILED ON THESE PLANS SHALL BE CONSTRUCTED IN ACCORDANCE WITH "STANDARD SPECIFICATIONS FOR PUBLIC WORKS CONSTRUCTION," STANDARD PLANS FOR PUBLIC WORKS CONSTRUCTION (LATEST EDITION AND SUPPLEMENTS), THE UNIFORM BUILDING CODE (FOR EXCAVATION AND GRADINGS), CALIFORNIA BUILDING CODE (CBC) AND ROSEMEAD SCHOOL DISTRICT STANDARD PLANS.
2. CONTRACTOR SHALL BE RESPONSIBLE FOR THE REPAIR, REPLACEMENT, AND MAINTENANCE OF EROSION CONTROL PLAN.
3. NO CONCRETE SHALL BE POURED UNTIL THE PROJECT INSPECTOR HAS INSPECTED AND APPROVED THE FOOTING EXCAVATIONS.
4. IF AT ANY TIME DURING THE GRADING AND EXCAVATION OPERATIONS, UNFAVORABLE SOILS CONDITIONS ARE ENCOUNTERED, THE WORK SHALL STOP UNTIL APPROVED CORRECTIVE MEASURES ARE OBTAINED.
5. ALL GRADES AND CONTOURS INDICATED ON THE PLANS ARE TO FINISHED SURFACE, AND NOT ROUGH GRADES. CONTRACTOR SHALL SUBTRACT THE STRUCTURAL THICKNESS OF PAVEMENTS AND TOP-SOIL THICKNESS IN LANDSCAPED AREAS, TO OBTAIN DESIRED ROUGH GRADES.
6. NO FILL TO BE PLACED, UNTIL THE PROJECT INSPECTOR HAS INSPECTED AND APPROVED THE BOTTOM EXCAVATION.
7. ALL CONCENTRATED DRAINAGE MUST BE CONDUCTED TO THE STREET IN APPROVED NON-EROSIVE DEVICES OR TO EXISTING STORM DRAIN SYSTEM.
8. EXCAVATIONS SHALL BE MADE IN ACCORDANCE WITH THE REGULATIONS OF THE STATE OF CALIFORNIA, DIVISION OF INDUSTRIAL SAFETY. ALL EXCAVATIONS SHALL BE STABILIZED WITHIN 30 DAYS OF INITIAL EXCAVATION. ALL TEMPORARY EXCAVATIONS SHALL BE DONE IN ACCORDANCE WITH THE RECOMMENDATIONS OF THE GEOTECHNICAL REPORT.
9. MAN MADE FILL SHALL BE COMPACTED TO A MINIMUM RELATIVE COMPACTION OF 90% MAX. DRY DENSITY, UNLESS A LOWER RELATIVE COMPACTION (NO LESS THAN 90% OF MAX. DRY DENSITY) IS JUSTIFIED BY THE SOILS ENGINEER.
10. THIS PLAN IS FOR GRADING PURPOSES ONLY AND DOES NOT CONSTITUTE APPROVAL OF BUILDINGS.
11. ALL DEBRIS AND FOREIGN MATERIAL SHALL BE REMOVED FROM THE SITE AND DISPOSED OF AT APPROVED DISPOSAL SITES. THE CONTRACTOR SHALL OBTAIN NECESSARY PERMITS FOR THE TRANSPORTATION OF MATERIAL TO AND FROM THE SITE.
12. EXISTING TOPOGRAPHY SHOWN HEREON WAS TAKEN FROM A SURVEY DATED MARCH 11 2022 BY CAL VADA SURVEYING, INC.
13. CONSTRUCTION STAKING FOR IMPROVEMENTS SHOWN ON THESE PLANS SHALL BE PERFORMED BY A LICENSED LAND SURVEYOR.
14. STRAIGHT GRADE SHALL BE MAINTAINED BETWEEN CONTOUR LINES AND SPOT ELEVATIONS UNLESS OTHERWISE SHOWN ON THE PLANS.
15. DIMENSIONS TO PIPELINES ARE TO CENTERLINE UNLESS OTHERWISE NOTED.
16. ALL DIMENSIONS ARE IN FEET OR DECIMALS THEREOF.
17. ALL CURB DIMENSIONS AND RADII ARE TO BOTTOM OF CURB FACE.
18. CONTRACTOR SHALL CONTACT UNDERGROUND SERVICE ALERT (USA) AT (800-422-4133) PRIOR TO ANY EXCAVATION.
19. CONTRACTOR TO BE AWARE OF ALL OVERHEAD LINES AT ALL TIMES, SO AS NOT TO DISTURB THEM.
20. CONTRACTOR SHALL COORDINATE REMOVAL OR RELOCATION OF ANY PUBLIC UTILITY LINES (IF ENCOUNTERED DURING CONSTRUCTION) WITH THEIR RESPECTIVE OWNERS. SEPARATE PERMITS MAY BE REQUIRED.
21. THE CONTRACTOR SHALL REPLACE ALL EXISTING IMPROVEMENTS DAMAGED DURING CONSTRUCTION AT HIS OWN EXPENSE AND TO THE SATISFACTION OF THE OWNER. MATCH EXISTING MATERIALS, SURFACE TREATMENT, AND COLORS. SAME SHALL APPLY TO PERMANENT UTILITY TRENCH RESURFACING.
22. STORM DRAINAGE SHOWN ON THESE PLANS HAVE BEEN DESIGNED FOR THE FINAL SITE CONDITION AT COMPLETION OF THE PROJECT. THE CONTRACTOR IS RESPONSIBLE FOR MAINTAINING ADEQUATE DRAINAGE OF THE SITE, DURING INTERIM CONDITIONS OF CONSTRUCTION.
23. CUT AND FILL SLOPES SHALL BE NO STEEPER THAN TWO HORIZONTAL ONE VERTICAL.
24. ANY TEMPORARY STOCKPIILING OF EXCESS MATERIAL ON SITE SHALL BE APPROVED BY THE PROJECT INSPECTOR AND THE OWNER'S AUTHORIZED REPRESENTATIVE, INCLUDING PROTECTION AND EROSION CONTROL, PRIOR TO EXCAVATION.
25. PROJECT INSPECTOR IS REQUIRED ON GRADING AND FOUNDATION EARTHWORK.
26. STAKE AND FLAG THE PROPERTY LINES IN ACCORDANCE WITH A LICENSED SURVEY MAP.
27. CONTINUOUS INSPECTION BY THE SOIL ENGINEER/GEOLOGIST IS REQUIRED AS DESCRIBED IN THE SOIL REPORT.

NOTICE TO CONTRACTORS:

1. PRIOR TO COMMENCING CONSTRUCTION, THE CONTRACTOR SHALL VERIFY ALL JOIN ELEVATION CONDITIONS FOR GRADING AND DRAINAGE WORK. IF CONDITIONS DIFFER FROM THOSE SHOWN ON THE PLANS, THE CONTRACTOR SHALL NOTIFY THE ENGINEER AND SHALL NOT BEGIN CONSTRUCTION UNTIL THE CHANGED CONDITIONS HAVE BEEN EVALUATED.
2. THE EXISTENCE, LOCATION AND CHARACTERISTICS OF UNDERGROUND UTILITY INFORMATION SHOWN ON THESE PLANS HAVE BEEN OBTAINED FROM A REVIEW OF AVAILABLE RECORD DATA. NO REPRESENTATION IS MADE AS TO THE ACCURACY OR COMPLETENESS OF SAID UTILITY INFORMATION. THE CONTRACTOR SHALL TAKE PRECAUTIONARY MEASURES TO PROTECT THE UTILITY LINES SHOWN AND ANY OTHER LINES NOT OF RECORD OR NOT SHOWN ON THESE PLANS.
3. THE CONTRACTOR FURTHER SHALL ASSUME SOLE AND COMPLETE RESPONSIBILITY FOR JOB SITE CONDITIONS, INCLUDING SAFETY OF ALL PERSONS AND PROPERTY, DURING THE COURSE OF CONSTRUCTION OF THIS PROJECT. THIS REQUIREMENT SHALL APPLY CONTINUOUSLY, AND SHALL NOT BE LIMITED TO NORMAL WORKING HOURS. THE CONTRACTOR SHALL DEFEND, INDEMNIFY AND HOLD THE OWNER AND ENGINEER HARMLESS FROM ANY AND ALL LIABILITY, REAL OR ALLEGED, IN CONNECTION WITH THE PERFORMANCE OF WORK ON THIS PROJECT.
4. THE CONTRACTOR SHALL FAMILIARIZE HIMSELF WITH THE PLANS, THE SOILS AND/OR GEOLOGY REPORTS, AND THE SITE CONDITIONS PRIOR TO COMMENCING WORK.
5. THE CONTRACTOR SHALL BE RESPONSIBLE FOR THE REVIEW AND COORDINATION OF ALL DRAWINGS AND SPECIFICATIONS PRIOR TO THE START OF CONSTRUCTION. ANY DISCREPANCIES THAT OCCUR SHALL BE BROUGHT TO THE ATTENTION OF THE ARCHITECT OR THE ENGINEER, PRIOR TO THE START OF CONSTRUCTION SO THAT A CLARIFICATION CAN BE ISSUED. ANY WORK PERFORMED IN CONFLICT WITH THE CONTRACT DOCUMENTS OR ANY CODE REQUIREMENTS SHALL BE CORRECTED BY THE CONTRACTOR AT THEIR OWN EXPENSE AND NOT TO THE EXPENSE OF THE OWNER OR ENGINEER.
6. ALL CHANGES TO THE CONSTRUCTION DOCUMENTS FOR THIS PROJECT SHALL BE DONE IN WRITING AND APPROVED BY THE ENGINEER OF RECORD. THE ENGINEER SHALL NOT BE RESPONSIBLE, OR LIABLE FOR UNAUTHORIZED CHANGES OR USES OF THE CONSTRUCTION DOCUMENTS.
7. SHOULD CONFLICTING INFORMATION BE FOUND ON THE PLANS, THE CONTRACTOR SHALL NOTIFY THE PROJECT ARCHITECT OR ENGINEER BEFORE PROCEEDING WITH THE WORK IN QUESTION.
8. THE CONTRACTOR SHALL OBTAIN AN OCCUPATIONAL SAFETY AND HEALTH ADMINISTRATION (O.S.H.A.) PERMIT FROM THE CALIFORNIA DIVISION OF INDUSTRIAL SAFETY PRIOR TO THE CONSTRUCTION OF TRENCHES OR EXCAVATIONS WHICH ARE 5 FEET OR DEEPER.
9. NOTES AND DETAILS ON DRAWINGS SHALL TAKE PRECEDENCE OVER GENERAL NOTES AND TYPICAL DETAILS.

ENVIRONMENTAL QUALITY NOTES:

- A. ALL UNPAVED DEMOLITION AND CONSTRUCTION AREAS SHALL BE WETTED AT LEAST TWICE DAILY DURING EXCAVATION AND CONSTRUCTION, AND TEMPORARY DUST COVERS SHALL BE USED TO REDUCE DUST EMISSIONS AND MEET SCAQMD DISTRICT RULE 403.
- B. THE CONTRACTOR SHALL KEEP THE CONSTRUCTION AREA SUFFICIENTLY DAMPENED TO CONTROL DUST CAUSED BY CONSTRUCTION AND HAULING, AND AT ALL TIMES PROVIDE REASONABLE CONTROL OF DUST CAUSED BY WIND.
- C. EROSION CONTROL TO BE INSTALLED YEAR ROUND THROUGHOUT ENTIRE PROJECT. OBTAIN GRADING INSPECTOR'S APPROVAL OF PROPOSED PROCEDURES.
- D. ALL LOADS SHALL BE SECURED BY TRIMMING, WATERING OR OTHER APPROPRIATE MEANS TO PREVENT SPILLAGE AND DUST.
- E. ALL MATERIALS TRANSPORTED OFF-SITE SHALL BE EITHER SUFFICIENTLY WATERED OR SECURELY COVERED TO PREVENT EXCESSIVE AMOUNT OF DUST.
- F. ALL CLEARING, EARTH MOVING, OR EXCAVATION ACTIVITIES SHALL BE DISCONTINUED DURING PERIODS OF HIGH WINDS (I.E., GREATER THAN 15 MPH), SO AS TO PREVENT EXCESSIVE AMOUNTS OF DUST.
- G. GENERAL CONTRACTORS SHALL MAINTAIN AND OPERATE CONSTRUCTION EQUIPMENT SO AS TO MINIMIZE EXHAUST EMISSIONS.
- H. THE PROJECT SHALL COMPLY WITH THE NOISE ORDINANCES WHICH PROHIBIT THE EMISSION OR CREATION OF NOISE BEYOND CERTAIN LEVELS AT ADJACENT USES UNLESS TECHNICALLY INFEASIBLE.
- I. CONSTRUCTION AND DEMOLITION SHALL BE RESTRICTED TO THE HOURS OF 7:00 AM TO 6:00 PM MONDAY THROUGH FRIDAY, AND 8:00 AM TO 6:00 PM ON SATURDAY.
- J. CONSTRUCTION AND DEMOLITION ACTIVITIES SHALL BE SCHEDULED SO AS TO AVOID OPERATING SEVERAL PIECES OF EQUIPMENT SIMULTANEOUSLY.
- K. THE PROJECT CONTRACTOR SHALL USE POWER CONSTRUCTION EQUIPMENT WITH STATE-OF-THE-ART NOISE SHIELDING AND MUFFLING DEVICES.
- L. THE CONTRACTOR SHALL COMPLY WITH THE NOISE INSULATION STANDARDS OF TITLE 24 OF THE CALIFORNIA CODE REGULATIONS, WHICH INSURE AN ACCEPTABLE INTERIOR NOISE ENVIRONMENT.
- M. ALL WASTE SHALL BE DISPOSED OF PROPERLY. USE APPROPRIATELY LABELED RECYCLING BINS TO RECYCLE CONSTRUCTION MATERIALS INCLUDING: SOLVENTS, WATER-BASED PAINTS, VEHICLE FLUIDS, BROKEN ASPHALT AND CONCRETE, WOOD, AND VEGETARIAN. NON RECYCLABLE MATERIALS/WASTES SHALL BE TAKEN TO AN APPROPRIATE LANDFILL. TOXIC WASTES MUST BE DISCARDED AT A LICENSED REGULATED DISPOSAL SITE.
- O. PAVEMENT SHALL NOT BE HOSED DOWN AT MATERIAL SPILLS. DRY CLEANUP METHODS SHALL BE USED WHENEVER POSSIBLE.
- P. DUMPSTERS SHALL BE COVERED AND MAINTAINED. UNCOVERED DUMPSTERS SHALL BE PLACED UNDER A ROOF OR BE COVERED WITH TARPS OR PLASTIC SHEETING.
- Q. GRAVEL APPROACHES SHALL BE USED WHERE TRUCK TRAFFIC IS FREQUENT TO REDUCE SOIL COMPACTION AND THE TRACKING OF SEDIMENT INTO STREETS SHALL BE LIMITED.
- R. ALL VEHICLE/EQUIPMENT MAINTENANCE, REPAIR, AND WASHING SHALL BE CONDUCTED AWAY FROM STORM DRAINS. ALL MAJOR REPAIRS SHALL BE CONDUCTED OFF-SITE. DRIP PANS OR DROP CLOTHES SHALL BE USED TO CATCH DRIPS AND SPILLS.

ACCESSIBILITY NOTES:

CALIFORNIA ACCESS COMPLIANCE, TITLE 24 CCR

1. WALKS AND SIDEWALK SURFACE CROSS SLOPES SHALL NOT EXCEED 1/4" PER FOOT (2% GRADIENT) (SEC. 11B-403.3)
2. WHEN THE SLOPE IN THE DIRECTION OF TRAVEL OF ANY WALK EXCEEDS 1:20 (5% GRADIENT) IT SHALL COMPLY WITH THE PROVISIONS OF SECTION 11B-401 AS A PEDESTRIAN RAMP (SEC. 11B-403.3)
3. WALK AND SIDEWALK SURFACES WITH A SLOPE OF LESS THAN 6% GRADIENT SHALL BE AT LEAST AS SLIP-RESISTANT AS THAT DESCRIBED AS A MEDIUM SALTED FINISH. (SEC. 11B-403.2)
4. WALK & SIDEWALK SURFACES WITH A SLOPE OF 6% OR MORE GRADIENT SHALL BE SLIP-RESISTANT. (SEC. 11B-403.2)
5. ALL WALKS WITH CONTINUOUS GRADIENTS SHALL HAVE LEVEL AREAS AT LEAST 5' IN LENGTH AT INTERVALS OF' AT LEAST EVERY 400'. (SEC. 11B-403.7)
6. WALKS SHALL BE PROVIDED WITH A LEVEL AREA NOT LESS THAN 60" WIDE AND DOOR+36" DEEP AT A DOOR OR GATE THAT SWINGS TOWARD THE WALK, AND NOT LESS THAN 48" WIDE AND DOOR+12" DEEP AT A DOOR OR GATE THAT SWINGS AWAY FROM THE WALK. (SEC. 11B-404.2.4.1 (c) OR (d))
7. WALKS AND SIDEWALKS SHALL HAVE A CONTINUOUS COMMON SURFACE, NOT INTERRUPTED BY STEPS OR BY ABRUPT CHANGES IN LEVEL EXCEEDING 1/2", AND SHALL BE A MINIMUM OF 48" WIDE. (SEC. 11B-403.1, 11B-403.2, 11B-403.5.1, 11B-403.5.3, 11B-302.1)
8. WHEN ABRUPT CHANGES IN LEVEL NOT EXCEEDING 1/2" OCCUR, THEY SHALL BE BEVELED WITH A SLOPE NO GREATER THAN 1 UNIT VERTICAL TO 2 UNITS HORIZONTAL (50%), EXCEPT THAT LEVEL CHANGES NOT EXCEEDING 3/4" MAY BE VERTICAL. (SEC. 11B-403.4 AND FIGURES 11B-5E (c) AND (d))
9. ABRUPT CHANGES IN LEVEL ALONG ANY ACCESSIBLE ROUTE EXCEEDING 1/2" SHALL COMPLY WITH THE REQUIREMENTS FOR CURB RAMPS. (SEC. 11B-303.4)
10. WALKS SHALL EXTEND A MINIMUM OF 36" TO THE SIDE OF THE STRIKE EDGE OF A DOOR OR GATE THAT SWINGS TOWARD THE WALL (SEC. 11B-404.2.4.1 (d))
11. WALKS, SIDEWALKS, AND PEDESTRIAN WAYS SHALL BE FREE OF GRATINGS WHEREVER POSSIBLE. GRID OPENINGS IN GRATINGS SHALL BE 1/2" WIDE MAX IN THE DIRECTION OF TRAFFIC FLOW. ELONGATED OPENINGS, IF PROVIDED SHALL BE PLACED SO THAT THE LONG DIMENSION IS PERPENDICULAR TO THE DOMINANT DIRECTION OF TRAVEL (SEC. 11B-302.3)
12. ABRUPT CHANGES IN LEVEL, 4" OR MORE, EXCEPT BETWEEN A WALK OR A SIDEWALK AND ADJACENT STREETS OR DRIVEWAYS SHALL BE IDENTIFIED BY A 6" HIGH CURBS ABOVE WALK SURFACE (SEC. 11B-303.5)
13. PROVIDE SIGNS DISPLAYING THE INTERNATIONAL SYMBOL OF ACCESSIBILITY AT EVERY PRIMARY PUBLIC ENTRANCE AND AT EVERY MAJOR JUNCTION ALONG OR LEADING TO AN ACCESSIBLE ROUTE OF TRAVEL. SIGNS SHALL INDICATE THE DIRECTION TO ACCESSIBLE BUILDING ENTRANCES AND SHALL COMPLY WITH SECTION 11B-703 (SEC. 11B-216.6)

PAVING NOTES:

1. A PRE-PAVING MEETING WITH PROJECT INSPECTOR AND ENGINEER IS REQUIRED 48 HOURS PRIOR TO PAVING.
2. CRUSHED AGGREGATE BASE SHOULD CONFORM TO SECTION 200-2.2 OF THE STANDARD SPECIFICATIONS FOR PUBLIC WORKS CONSTRUCTION AND SHOULD BE COMPACTED TO A DRY DENSITY OF AT LEAST 95 PERCENT OF THE MAXIMUM DRY DENSITY AT NEAR OPTIMUM MOISTURE CONTENT AS DETERMINED BY ASTM D 1557-02.
3. THE PCC PAVEMENT SHALL HAVE A MINIMUM COMPRESSIVE STRENGTH OF APPROXIMATELY 2,500 PSI FOR PEDESTRIAN AREAS.
4. ADJACENT PAVEMENTS SLAB SECTIONS SHALL HAVE FLUSH TRAPEZOIDAL KEYED CONSTRUCTION JOINT. AS AN ALTERNATIVE TO THE KEYED JOINT, DOWELING BETWEEN CONSTRUCTION JOINTS CAN BE USED. DOWELS SHALL CONSIST OF SMOOTH, #4bar REINFORCING STEEL, 18 INCHES LONG, EMBEDDED A MINIMUM OF SIX INCHES INTO THE SLAB ON EITHER SIDE OF THE CONSTRUCTION JOINT.

CALIFORNIA CODE OF REGULATIONS:

LIST OF APPLICABLE CODES

2022 CALIFORNIA ADMINISTRATIVE CODE (CAC), PART 1, TITLE 24 CCR
2022 CALIFORNIA BUILDING CODE (CBC), PART 2, TITLE 24 CCR
2022 CALIFORNIA ELECTRICAL CODE (CEC), PART 3, TITLE 24 CCR
2022 CALIFORNIA MECHANICAL CODE (CMC), PART 4, TITLE 24 CCR
2022 CALIFORNIA PLUMBING CODE (CPC), PART 5, TITLE 24 CCR
2022 CALIFORNIA ENERGY CODE, PART 6, TITLE 24 CCR
2022 CALIFORNIA FIRE CODE (CFC), PART 9, TITLE 24 CCR
2022 CALIFORNIA EXISTING BUILDING CODE (CEBC), PART 10, TITLE 24 CCR
2022 CALIFORNIA GREEN BUILDING STANDARDS CODE (CALGREEN), PART 11, TITLE 24 CCR
2022 CALIFORNIA REFERENCED STANDARDS CODE, PART 12, TITLE 24 CCR
TITLE 19 CCR, PUBLIC SAFETY, STATE FIRE MARSHAL REGULATIONS

APPLICABLE STANDARDS

FOR A LIST OF APPLICABLE STANDARDS, INCLUDING CALIFORNIA AMENDMENTS TO THE NFPA STANDARDS, REFER TO CBC CHAPTER 35 AND CFC CHAPTER 80.

BENCH MARK

ELEVATIONS SHOWN HEREON ARE BASED UPON LOS ANGELES COUNTY BENCHMARK MC3252, ELEVATION 323.41 FEET (NAVD 88).

DESCRIPTION: RDBM TAG IN W CB 1FT N/O BCR @ NW COR VALLEY BLVD & WALNUT GROVE AVE.

SITE INFORMATION

SITE NAME: MILDRED B. JANSON ELEMENTARY SCHOOL

SITE ADDRESS: 8628 MARSHALL STREET, ROSEMEAD, CA 91770
LOS ANGELES COUNTY

ASSESSOR'S PARCEL NO. 5390-004-901

BASIS OF BEARINGS

THE BEARINGS SHOWN HEREON ARE BASED UPON THE CALIFORNIA COORDINATE SYSTEM OF 1983, CCS83, ZONE 5, (2017.50) IN ACCORDANCE TO THE CALIFORNIA PUBLIC RESOURCES CODE SECTIONS 8801-8819; SAID BEARINGS ARE DETERMINED LOCALLY UPON FIELD-OBSERVED TIES TO THE FOLLOWING CALIFORNIA SPATIAL REFERENCE CENTER (C.S.R.C.) CONTINUOUSLY OPERATING REFERENCE STATIONS (C.O.R.S.):

C.S.R.C. RHCL: NORTHING = 1829315.58' EASTING = 6553739.69'

C.S.R.C. BKMS: NORTHING = 1808660.13' EASTING = 6532953.81'

THE COMBINATION FACTOR FOR THIS PROJECT WAS APPLIED AT THE FOLLOWING POINT:

NORTHING = 1849306.58' EASTING = 6537401.68'

MAPPING ANGLE = -0°02'44" SCALE FACTOR = 1.00001741

PROJECT SITE

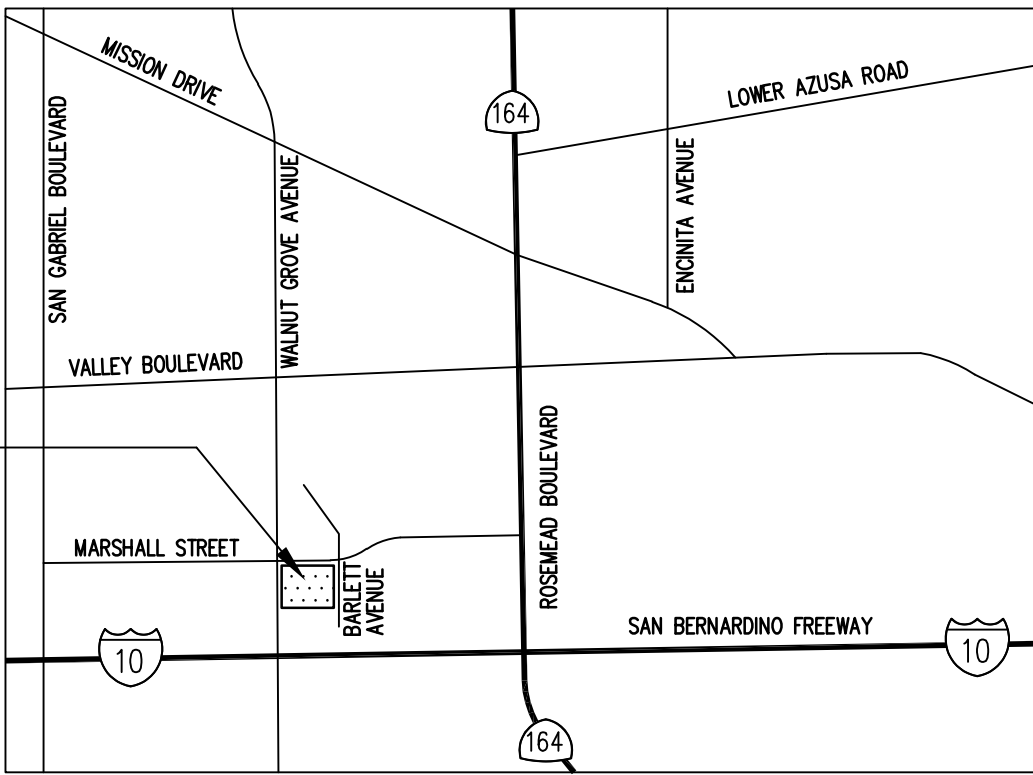

VICINITY MAP
SCALE: N.T.S.

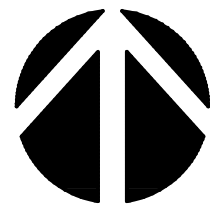

PREPARED BY

BRANDOW & JOHNSTON, INC.
700 SOUTH FLOWER ST., SUITE 1200
LOS ANGELES, CA. 90017
TEL (213) 596-4500
FAX (213) 596-4599

REPRESENTATIVE:

ED MELO, PE
DIRECTOR OF CIVIL ENGINEERING

PREPARED FOR

ROSEMEAD SCHOOL DISTRICT
3907 ROSEMEAD BLVD.
ROSEMEAD, CA 91770

REPRESENTATIVE:

NAC ARCHITECTURE
323-475-8075

INDEX OF DRAWINGS

SHT. NO.	DESCRIPTION
C1.01	TITLE SHEET AND GENERAL NOTES
C2.01	TYPICAL DETAILS
C3.01	SITE DEMOLITION PLAN
C4.01	PRECISE GRADING PLAN



BRANDOW & JOHNSTON
STRUCTURAL-CIVIL ENGINEERS
700 SOUTH FLOWER ST. #200, LOS ANGELES, CA 90017
TEL (213) 596-4500
WWW.B&J.COM



ROSEMEAD SCHOOL DISTRICT
MILDRED B. JANSON ELEMENTARY SCHOOL
CONSTRUCTION OF NEW PLAYGROUNDS

8628 MARSHALL ST., ROSEMEAD, CA 91770



ROSEMEAD
SCHOOL DISTRICT
3907 ROSEMEAD BLVD.,
ROSEMEAD, CA 91770

NAC
ARCHITECTURE
nacarchitecture.com
8274 Spring Street, Third Floor
Los Angeles, CA 90012-2323
P 323.475.8075

BAU NO. C23-0038
DRAWN VT
CHECKED EM
DATE 08/30/2023

TITLE SHEET
AND
GENERAL
NOTES

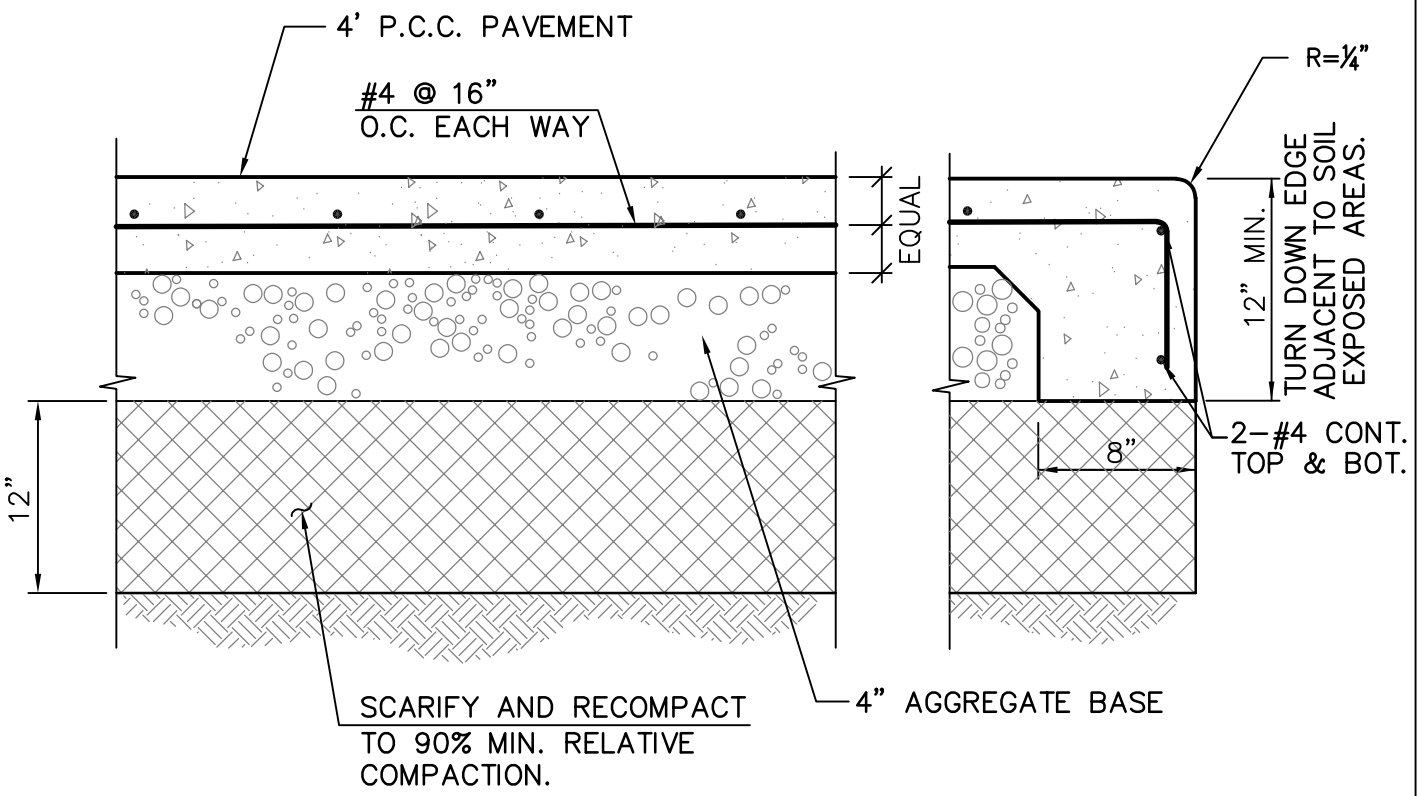
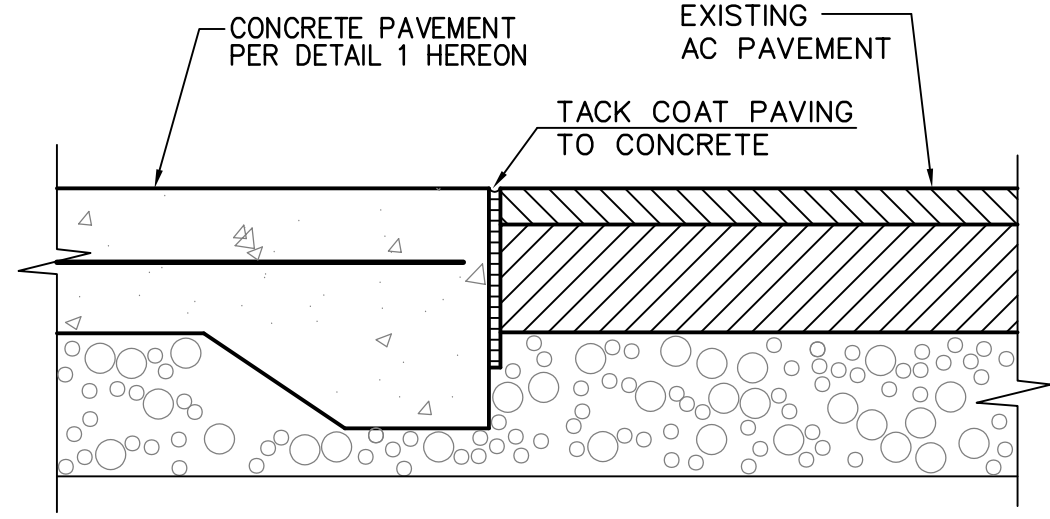

NOTES:

- 1 - PORTLAND CEMENT CONCRETE, $f_c=2500$ psi, W/C RATIO 0.5 MAX.
- 2 - EXPANSION JOINTS-PER DETAIL 2 HEREON. SPACING - 32' O.C. OR LESS TO FIT WITH CONTROL JOINT SPACING PER DETAIL 2 HEREON.
- 3 - CONTROL JOINTS - PER DETAIL 2 HEREON.
- 4 - FINISH - MATCH EXISTING.

AC TO CONCRETE PAVEMENT TRANSITION

SCALE:
NO SCALE

PEDESTRIAN CONCRETE PAVEMENT

SCALE:
NO SCALE

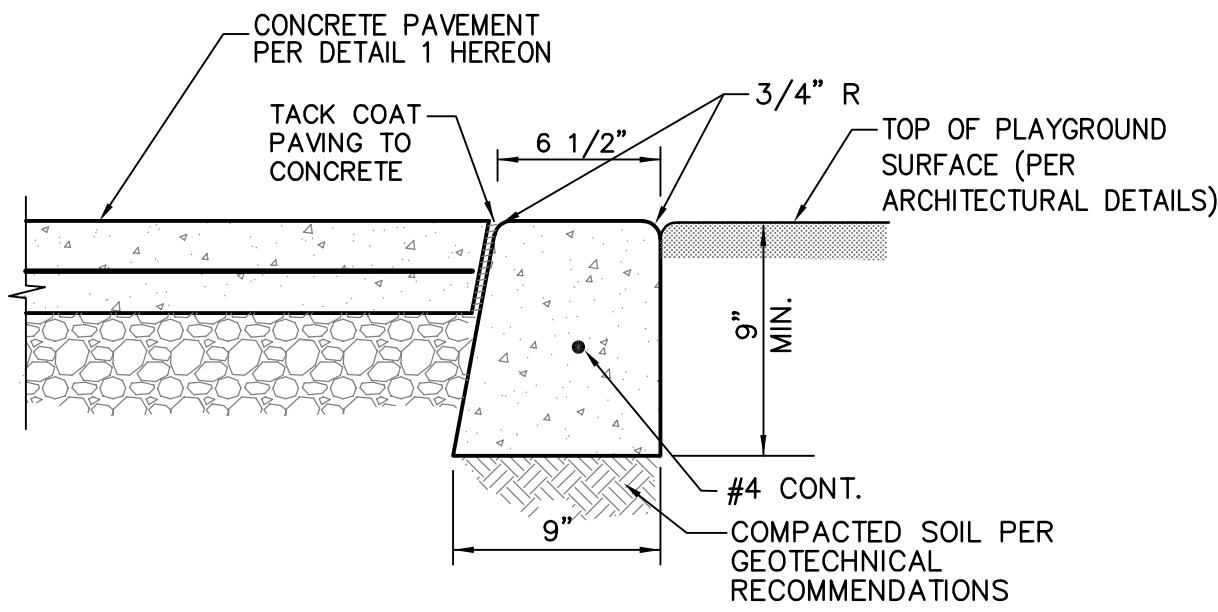

NOTES: (TYPICAL @ ALL SIMILAR CONDITIONS)

1. BOTTOM OF CURB TO BE SET ON SUBGRADE SOIL COMPACTED TO 95% STANDARD PROCTOR.
2. FINISH ALL EXPOSED CONCRETE SURFACES SMOOTH.
3. PROVIDE 1/2" EXPANSION JOINTS AT 25'-0" O.C. MAX. AND AT CURVES, TANGENTS AND CORNERS.
4. PORTLAND CEMENT CONCRETE, $f_c' = 3,200$ psi

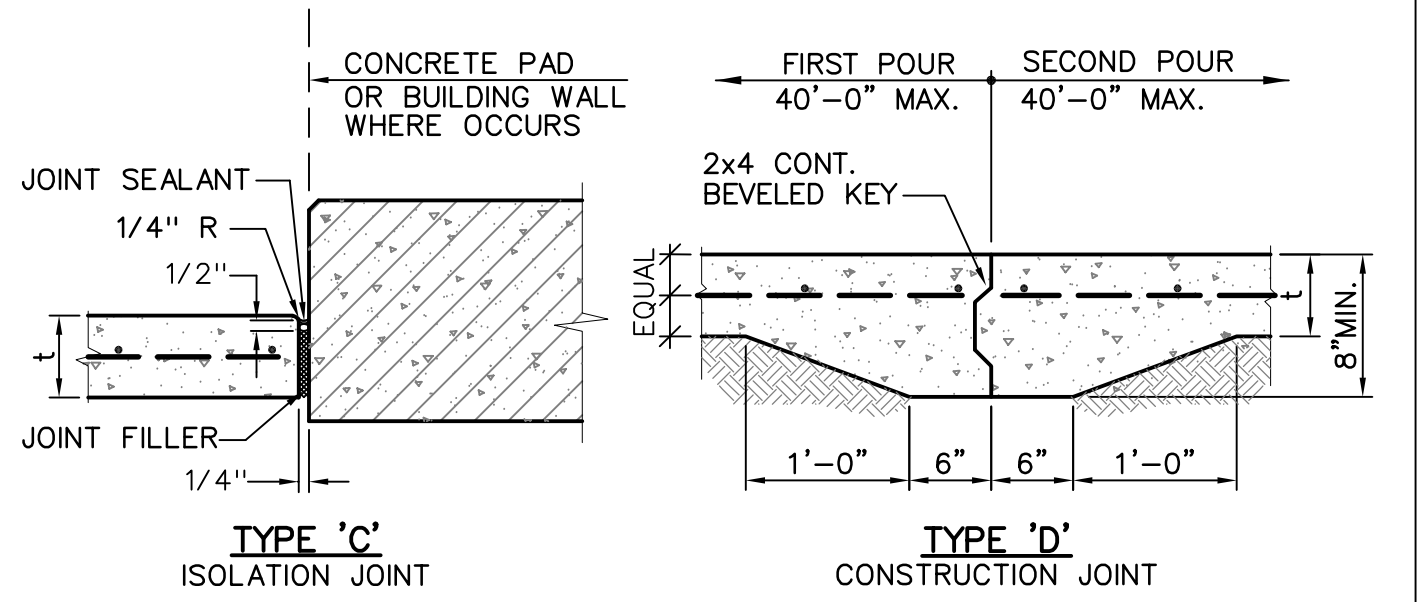
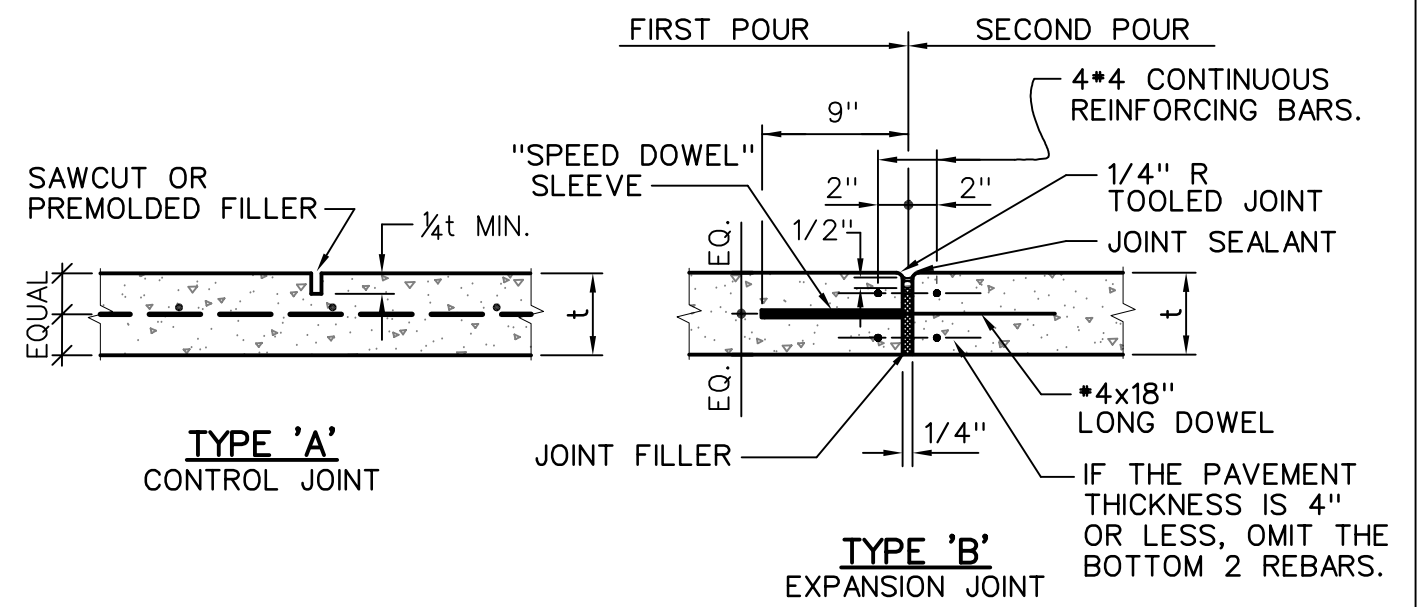

FLUSH CURB DETAIL AT CONC.

SCALE:
NO SCALE

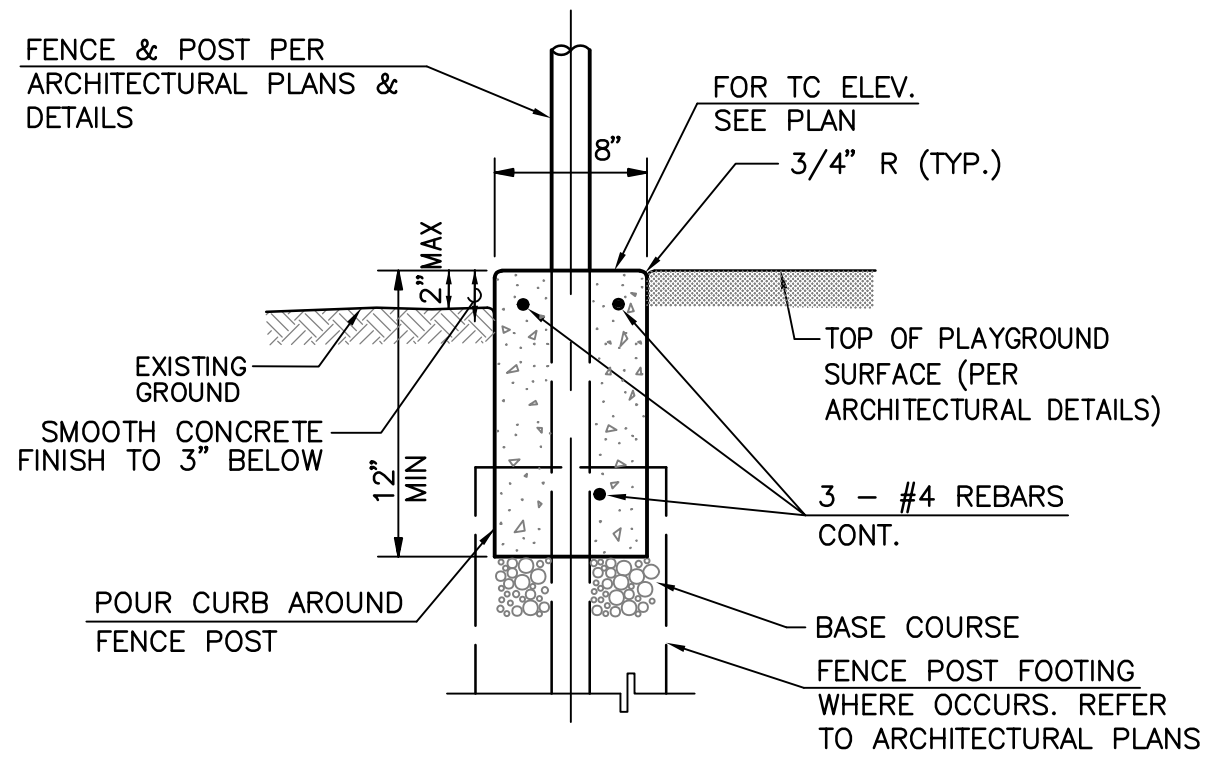

NOTES: (TYPICAL @ ALL SIMILAR CONDITIONS)

1. BOTTOM OF CURB TO BE SET ON SUBGRADE SOIL COMPACTED TO 95% STANDARD PROCTOR.
2. FINISH ALL EXPOSED CONCRETE SURFACES SMOOTH.
3. PROVIDE 1/2" EXPANSION JOINTS AT 25'-0" O.C. MAX. AND AT CURVES, TANGENTS AND CORNERS.
4. PORTLAND CEMENT CONCRETE, $f'_c=3200$ psi

CONCRETE CURB AT FENCE

SCALE:
NO SCALE

CONSTRUCTION JOINTS

SCALE:
NO SCALE

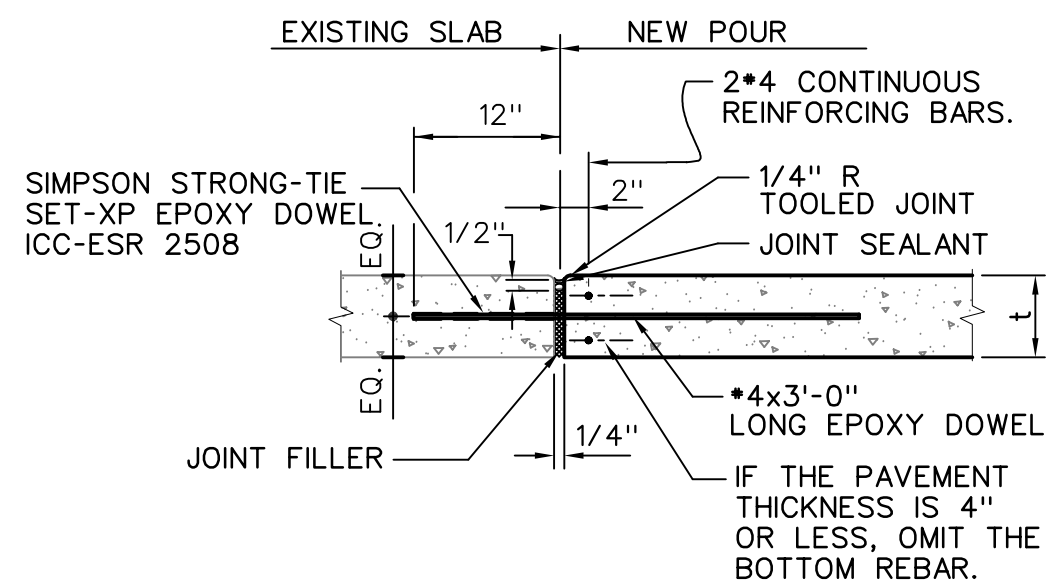

NOTES:

1. SEE SPECIFICATIONS FOR TYPE OF JOINT SEALANT AND JOINT FILLER.
2. PLACE THE DOWELS AT 24" O.C. (2 DOWELS MIN.)
3. 12" MAX. BETWEEN THE CONCRETE EDGE AND THE FIRST DOWEL.

CONSTRUCTION JOINT AT (E) CONC.

SCALE:
NO SCALE

FILE No.: 19-91 A#: 03-123587

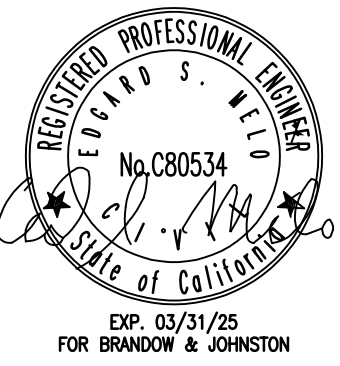

BRANDOW & JOHNSTON
STRUCTURAL+CIVIL ENGINEERS
700 S FLOWER ST #1200, LOS ANGELES, CA 90017
T: (213) 596-4500
WWW.BJSCE.COM



ROSEMEAD SCHOOL DISTRICT
MILDRED B. JANSON ELEMENTARY SCHOOL
CONSTRUCTION OF NEW PLAYGROUNDS

8628 MARSHALL ST., ROSEMEAD, CA 91770



ROSEMEAD
SCHOOL DISTRICT
3907 ROSEMEAD BLVD.,
ROSEMEAD, CA 91770

NAC
ARCHITECTURE
nacarchitecture.com
837 N. Spring Street, Third Floor
Los Angeles, CA 90012-2323
P:323.475.8075

BJ NO C23-0038
DRAWN VT
CHECKED EM
DATE 08/30/2023

TYPICAL DETAILS

C2.01

H:\C23-0038 - NAC RUSD Janson ES\Engineering\Drawings\Playgrounds\C3.01ds.dwg Plotted On Feb. 28, 2024--8:56am by vlatcheva



DEMOLITION NOTES:

- 1. REMOVE EXISTING LANDSCAPE.
- 2. REMOVE EXISTING FENCE.

SALVAGE NOTES:

- A. PROTECT EXISTING LANDSCAPE.
- B. PROTECT EXISTING TREE.
- C. PROTECT EXISTING CONCRETE SIDEWALK.
- D. PROTECT EXISTING UTILITY APPURTENANCE.
- E. PROTECT EXISTING ASPHALT PAVEMENT.
- F. PROTECT EXISTING FENCE.

LEGEND:

- [Dashed Line] LIMITS OF DEMOLITION
- [Solid Line] EXISTING BUILDING
- [Long Dashed Line] PROPERTY LINE
- [Short Dashed Line] SAWCUT LINE

NOTE:

- 1. NO DEMOLITION SHALL BEGIN UNTIL PLANS INCLUDING DEMOLITION WORK HAVE BEEN APPROVED BY DSA.



SITE DEMOLITION PLAN

0' 10' 20' 40'
GRAPHIC SCALE : 1"=20'

FILE No.: 19-91 A#: 03-123587

REV. DATE DESCRIPTION



BRANDOW & JOHNSTON
STRUCTURAL-CIVIL ENGINEERS
7702 MARSHALL ST. #1201, LOS ANGELES, CA 90047
TEL: 213-358-4628 WWW.B&JSE.COM



ROSEMEAD SCHOOL DISTRICT
MILDRED B. JANSON ELEMENTARY SCHOOL
CONSTRUCTION OF NEW PLAYGROUNDS

8628 MARSHALL ST., ROSEMEAD, CA 91770

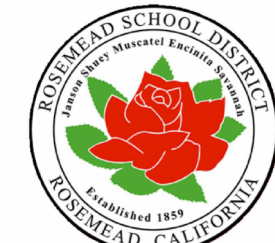

ROSEMEAD
SCHOOL DISTRICT
3807 ROSEMEAD BLVD.,
ROSEMEAD, CA 91770

NAC
ARCHITECTURE
nacarchitecture.com
837 N. Spring Street, Third Floor
Los Angeles, CA 90012-2323
P: 323.475.8075

BAJ NO. C23-0038
DRAWN VT
CHECKED EM
DATE 08/30/2023

SITE
DEMOLITION
PLAN

C3.01

- ① CONSTRUCT PLAY STRUCTURE MAT PER ARCHITECTURAL PLANS.
- ② CONSTRUCT CONCRETE PAVEMENT PER DETAIL 1 ON SHEET C2.01.
- ③ CONSTRUCT FLUSH CONCRETE CURB PER DETAIL 5 ON SHEET C2.01.
- ④ CONSTRUCT FLUSH CONCRETE CURB AT FENCE PER DETAIL 6 ON SHEET C2.01.
- ⑤ CONSTRUCT NEW TO EXISTING CONCRETE TRANSITION PER DETAIL 3 ON SHEET C2.01.
- ⑥ CONSTRUCT NEW CONCRETE TO EXISTING ASPHALT PAVEMENT TRANSITION PER DETAIL 4 ON SHEET C2.01.

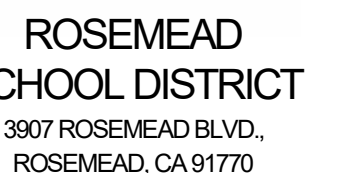

JNO C23-0038
 AWW VT
 ECKED EM
 TE 08/30/2023

C4.01

